

# PARTS AND EXPLODED VIEWS

MANUFACTURER : HISENSE / ELEMENT

MODEL : **FLX3220F**

NOTE : HISENSE / ELEMENT





# PARTS LIST AND EXPLODED VIEW

**32" COLOR LCD TELEVISION**

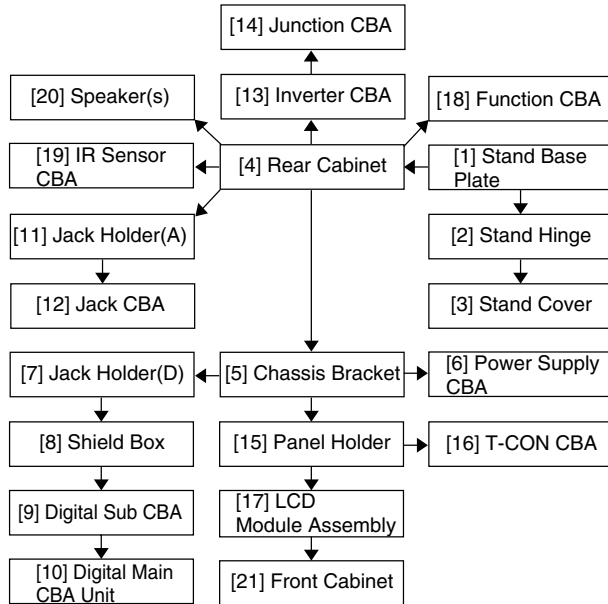
**FLX3220F**



# CABINET DISASSEMBLY INSTRUCTIONS

## 1. Disassembly Flowchart

This flowchart indicates the disassembly steps for the cabinet parts, and the CBA in order to gain access to item(s) to be serviced. When reassembling, follow the steps in reverse order. Bend, route and dress the cables as they were.



## 2. Disassembly Method

Step/ Loc. No.	Part	Removal		
		Fig. No.	Remove/*Unhook/ Unlock/Release/ Unplug/Unclamp/ Desolder	Note
[1]	Stand Base Plate	D1	4(S-1), 6(S-2), 5(S-3)	---
[2]	Stand Hinge	D1	-----	---
[3]	Stand Cover	D1	-----	---
[4]	Rear Cabinet	D1	11(S-4), 4(S-5)	---
[5]	Chassis Bracket	D2	8(S-6)	---
[6]	Power Supply CBA	D2 D5	4(S-7), *CN101B, *CN501, *CN801, *CN802, *CN3010, *CN3014	---
[7]	Jack Holder(D)	D2	(S-8), (S-9), (N-1)	---
[8]	Shield Box	D2	5(S-11), *CN3001, Shield Plate	---
[9]	Digital Sub CBA	D2 D5	*CN1	---

Step/ Loc. No.	Part	Removal		
		Fig. No.	Remove/*Unhook/ Unlock/Release/ Unplug/Unclamp/ Desolder	Note
[10]	Digital Main CBA Unit	D2 D5	*CN3002, *CN3018, *CN3023	---
[11]	Jack Holder(A)	D3	(S-12)	---
[12]	Jack CBA	D3 D5	5(S-13)	---
[13]	Inverter CBA	D3 D5	6(S-14), *CN1050, *CN1100, *CN1150, *CN1200, *CN1250, *CN1300	---
[14]	Junction CBA	D3 D5	Desolder	---
[15]	Panel Holder	D3	8(S-15), 2(S-16)	---
[16]	T-CON CBA	D4 D5	6(S-17), Shield Plate, *CN9001, *CN9002, *CN9005	---
[17]	LCD Module Assembly	D4	6(S-18)	---
[18]	Function CBA	D4 D5	3(S-19)	---
[19]	IR Sensor CBA	D4 D5	2(S-20)	---
[20]	Speaker(s)	D4	8(S-21)	---
[21]	Front Cabinet	D4	-----	---

↓  
(1)

↓  
(2)

↓  
(3)

↓  
(4)

↓  
(5)

### Note:

(1) Order of steps in procedure. When reassembling, follow the steps in reverse order. These numbers are also used as the Identification (location) No. of parts in figures.

(2) Parts to be removed or installed.

(3) Fig. No. showing procedure of part location

(4) Identification of parts to be removed, unhooked, unlocked, released, unplugged, unclamped, or desoldered.

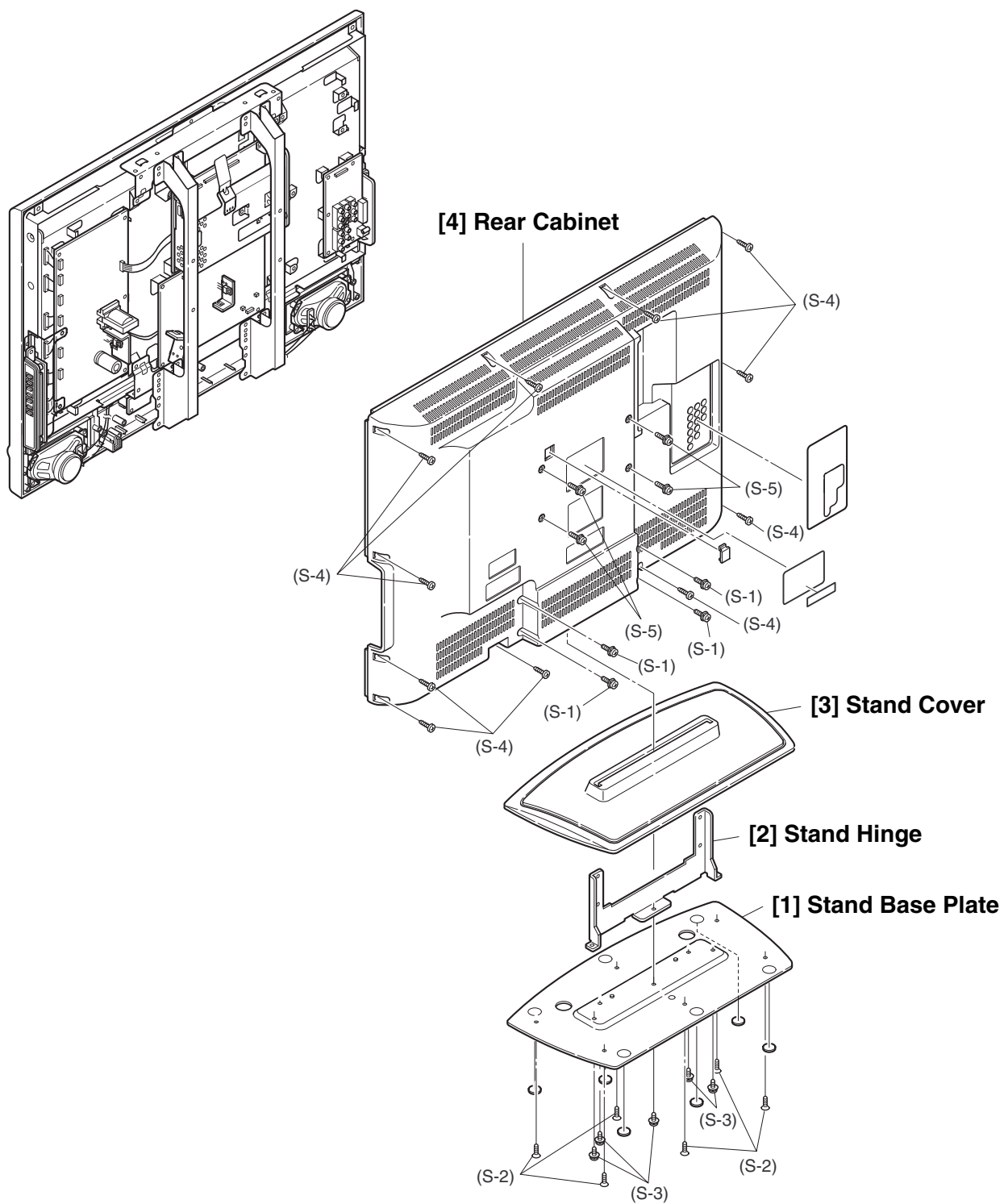
N = Nut, L = Locking Tab, S = Screw,  
CN = Connector

\* = Unhook, Unlock, Release, Unplug, or Desolder

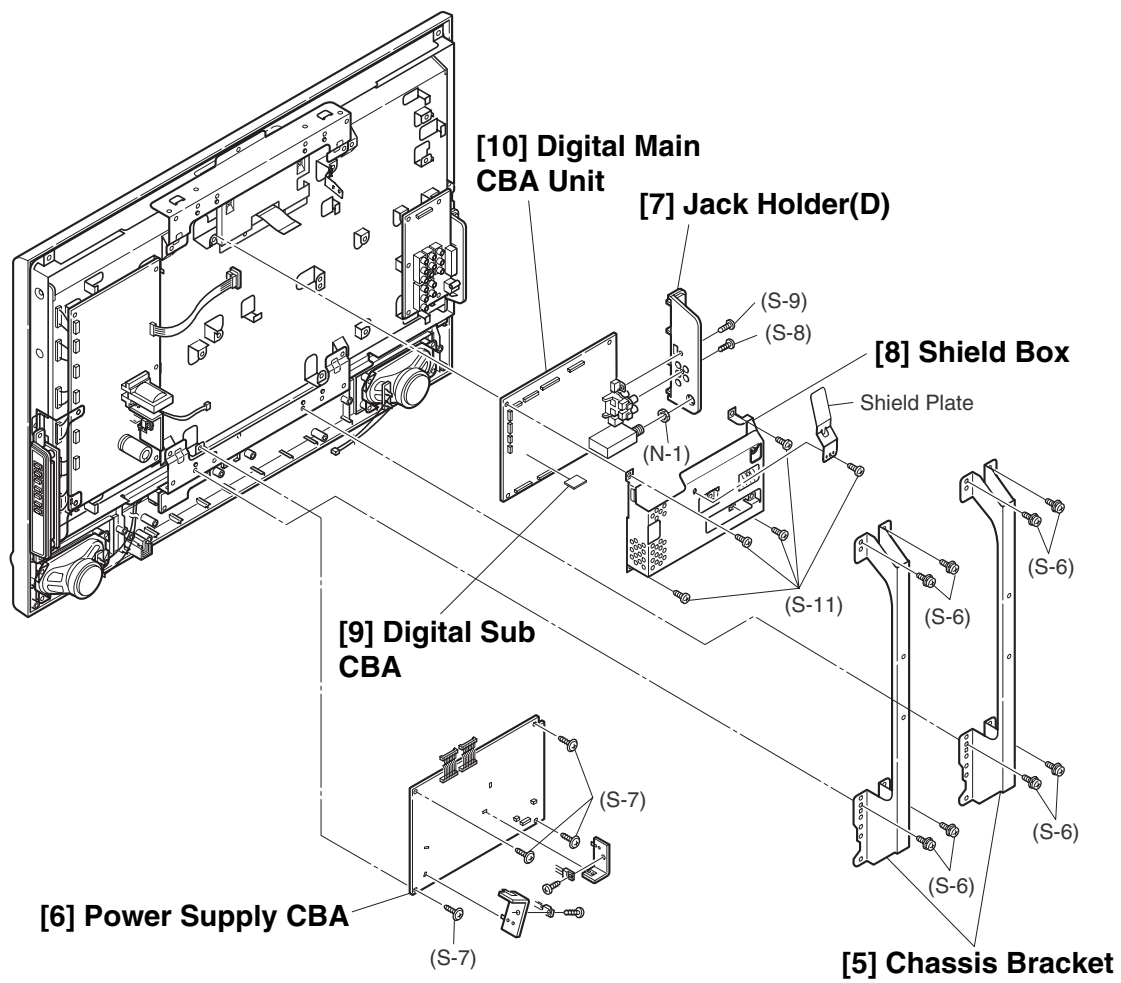
e.g. 2(S-2) = two Screws (S-2),

2(L-2) = two Locking Tabs (L-2)

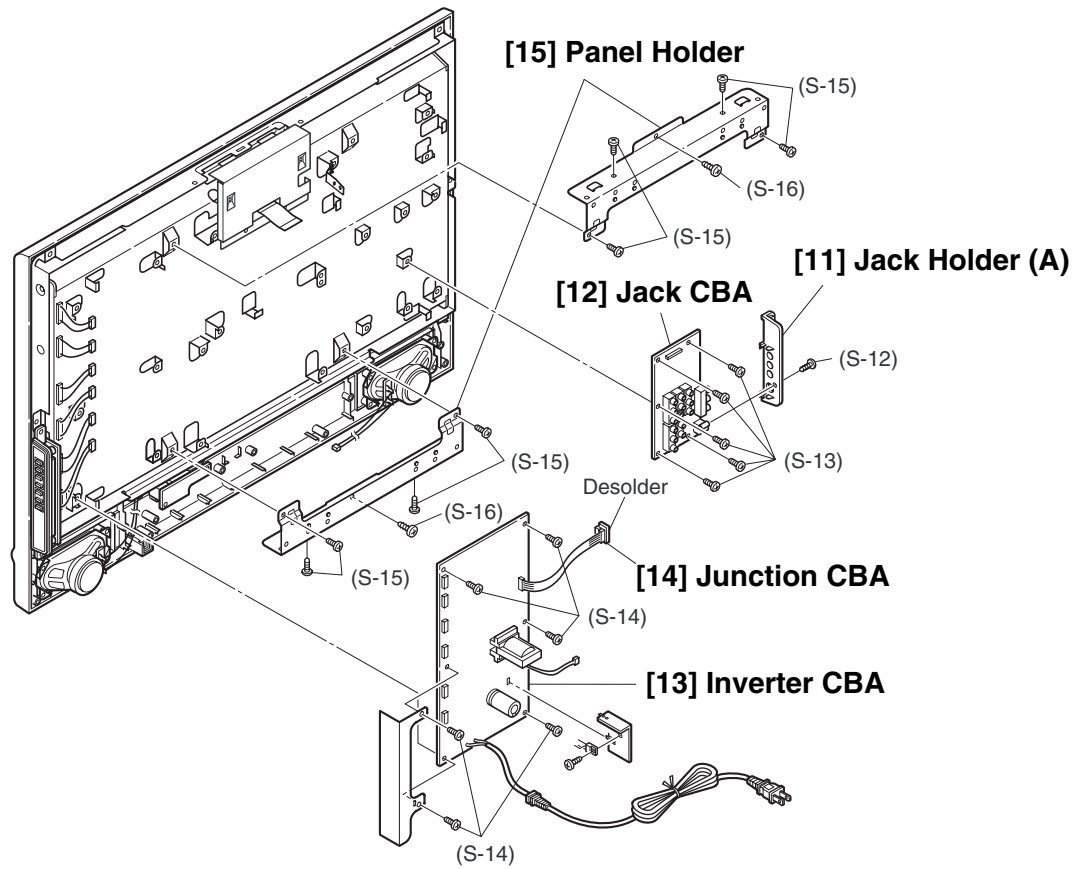
(5) Refer to the following "Reference Notes in the Table."



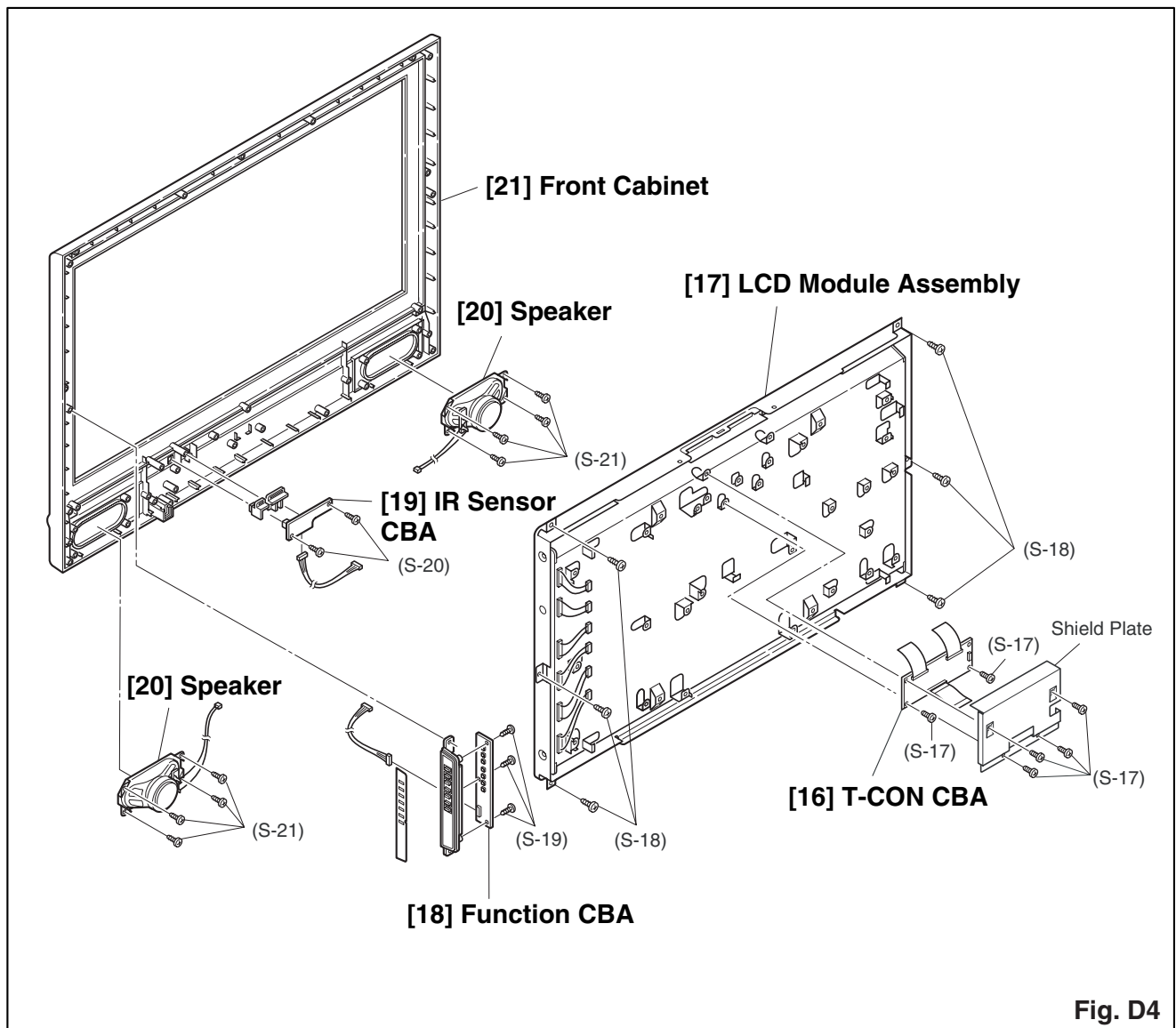
**Fig. D1**



**Fig. D2**

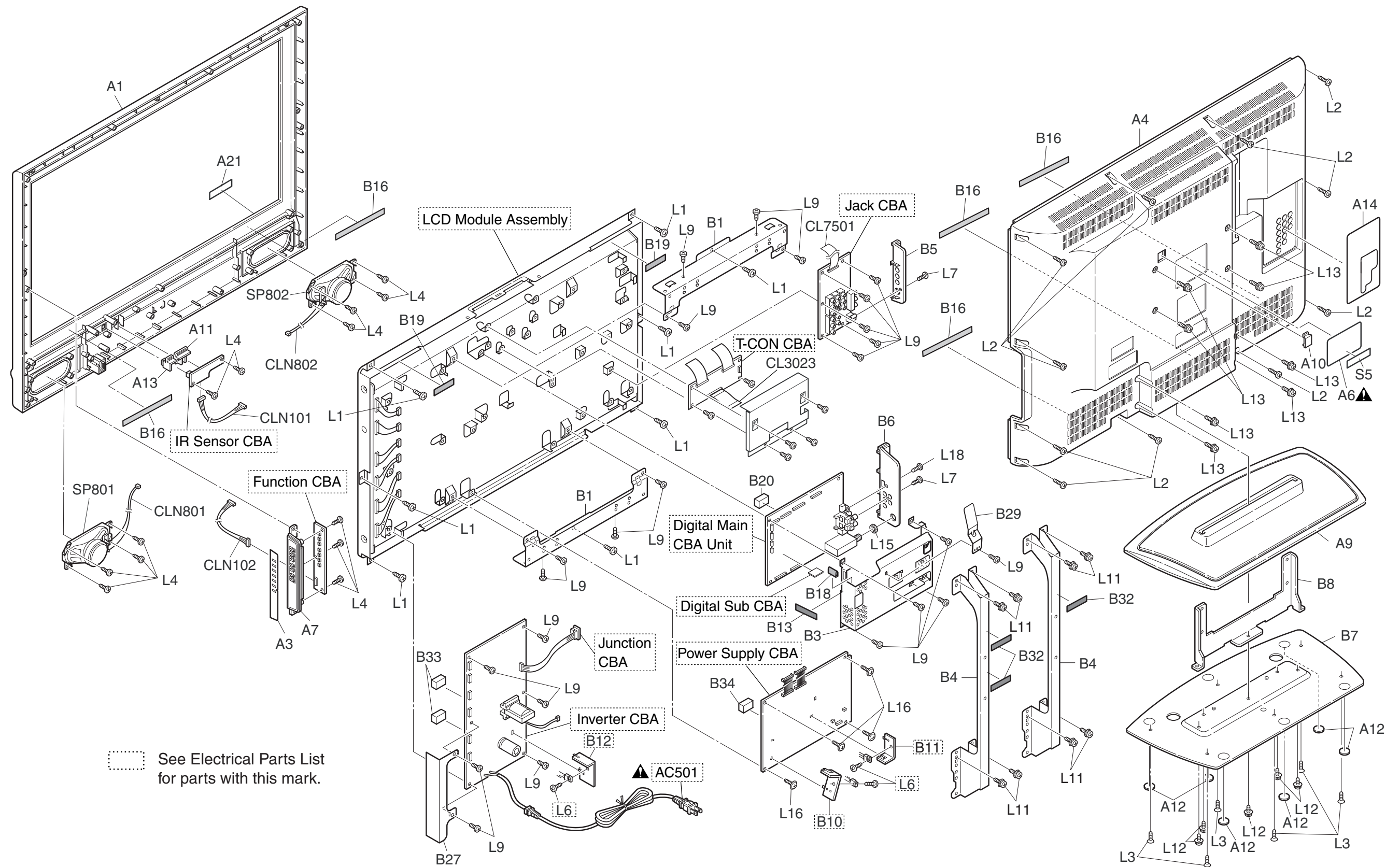


**Fig. D3**



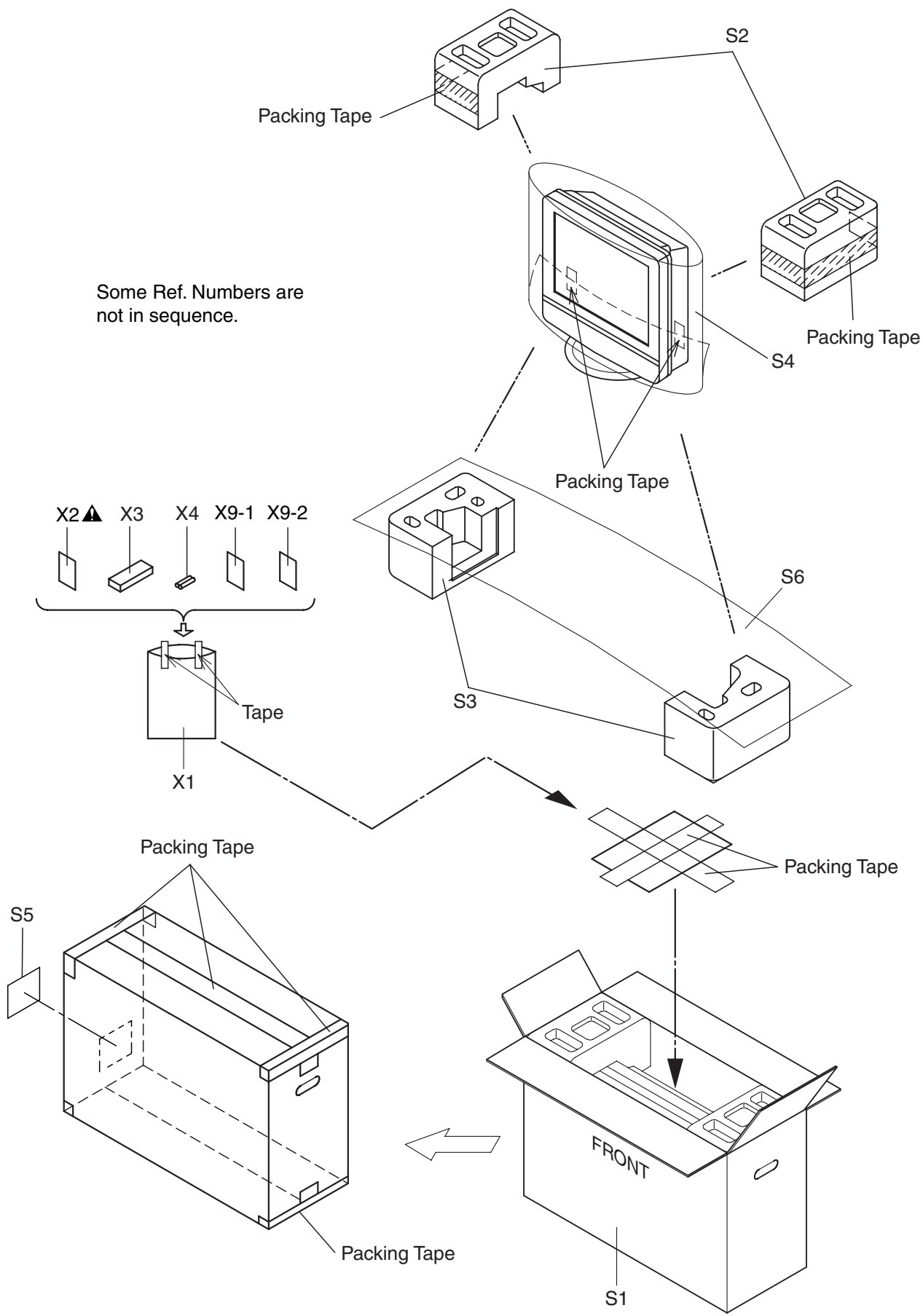
**Fig. D4**

## Cabinet






Packing

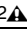


# MECHANICAL PARTS LIST


**PRODUCT SAFETY NOTE:** Products marked with a  have special characteristics important to safety. Before replacing any of these components, read carefully the product safety notice in this service manual. Don't degrade the safety of the product through improper servicing.

**NOTE:** Parts that are not assigned part numbers (-----) are not available.

Ref. No.	Description	Part No.
A1	FRONT CABINET A71F6UH	1EM021927
A3	CONTROL PLATE A71F0UH	1EM322471
A4	REAR CABINET A71F4UH	1EM021796
A6 	RATING LABEL A71F6UH	-----
A7	FUNCTION KNOB A71F0UH	1EM121822
A9	STAND COVER A71F6UH	1EM021945
A10	REAR COVER A7260JH	1EM322484
A11	LED LENS A71A2UH	1EM322718
A12	STAND RUBBER FOOT L5001CB	1EM423855
A13	SENSOR LENS A71F0UH	1EM322470
A14	JACK PLATE A71A1UH	1EM221627
A21	POP LABEL A71F6UH	-----
B1	PANEL HOLDER 32V A71F0UH	1EM121831A
B3	SHIELD BOX A71F0UH	1EM121832A
B4	CHASSIS BRACKET 32V A71F0UH	1EM121806A
B5	JACK HOLDER(A) A71F0UH	1EM221530
B6	JACK HOLDER D A71A1UH	1EM221626
B7	STAND BASE PLATE A71F0UH	1EM121808A
B8	STAND HINGE A71F0UH	1EM221532A
B13	GRAND TAPE L4300UA	1EM423095
B16	CLOTH(10X180XT0.5) L0336JG	0EM408827
B18	CLOTH(10X30XT0.5) B5900UA	0EM404486
B19	CLOTH(20X65XT0.5) L0100JA	0EM407914
B20	GASKET A71F0UH	1EM424393
B27	INSULATION SHEET A71F0UH	1EM322580
B29	SHIELD PLATE A71F0UH	1EM322609
B32	GRAND TAPE (TR-19) A71F0UH	1EM424512
B33	RUBBER CUSHION (10X10X13) A71F0UH	1EM424527
B34	RUBBER CUSHION (10X10X20) A71F0UH	1EM424528
CL3023	WIRE ASSEMBLY 101 30PIN / 70MM	WX1A71F0-101
CL7501	WIRE ASSEMBLY 102 24PIN / 430MM	WX1A71F0-102
CLN101	WIRE ASSEMBLY 003 8PIN / 330MM / AWG26	WX1A71F0-003
CLN102	WIRE ASSEMBLY 002 6PIN / 905MM / AWG26	WX1A71F0-002
CLN801	WIRE ASSEMBLY 006 2PIN / 450MM / AWG22	WX1A71F0-006
CLN802	WIRE ASSEMBLY 005 2PIN / 280MM / AWG22	WX1A71F0-005
FIL101	CLAMP FILTER ZCAT1518-0730	XL03022TE001
L1	SCREW P-TIGHT 4X14 BIND HEAD	GBJP4140
L2	SCREW P-TIGHT M4X14 BIND HEAD+BLK	GBHP4140
L3	SCREW P-TIGHT M3X12 DISH HEAD+	GDJP3120
L4	SCREW P-TIGHT M3X10 BIND HEAD+	GBJP3100
L7	SCREW B-TIGHT 3X10 BIND HEAD+ BLK	GBHB3100
L9	SCREW S-TIGHT M3X6 BIND HEAD+	GBJS3060
L11	DOUBLE SEMS SCREW M4X6 M4X6	FPJ34060
L12	DOUBLE SEMS SCREW M4X9 + BLACK L0130UA	0EM408146A
L13	DOUBLE SEMS SCREW M4X10 + BLK	FPH34100
L15	NUT 3/8-32UNEF	0EM401451A
L16	ASSEMBLED SCREW ( D9 M3X6 ) A71F0UH	1EM424392
L18	SCREW S-TIGHT M3X8 BIND HEAD+	GBHS3080

Ref. No.	Description	Part No.
SP801	SPEAKER MAGNETIC YDP613-23	DSD1611EFU01
SP802	SPEAKER MAGNETIC YDP613-23	DSD1611EFU01
<b>PACKING</b>		
S1	CARTON A71F6UH	1EM425038
S2	STYROFOAM TOP A71F0UH	1EM021620
S3	STYROFOAM BOTTOM A71F0UH	1EM021621
S4	SET BAG L4300UA	1EM321546
S5	SERIAL NO. LABEL L9750UA	-----
S6	STAND SHEET L5001CB	1EM423856
<b>ACCESSORIES</b>		
X1	BAG POLYETHYLENE 235X365XT0.03	0EM408420A
X2 	OWNERS MANUAL A71F6UH	1EMN22599
X3	REMOTE CONTROL NF026UD 170/ ECNLC501/NF026UD	NF026UD
X4	DRY BATTERY(SUNRISE) R6SSE/2S	XB0M451MS002
X9-1	QUICK SETUP GUIDE 1 A71F6UH	1EMN22699
X9-2	QUICK SETUP GUIDE 2 A71F6UH	1EMN22700

# ELECTRICAL PARTS LIST

**PRODUCT SAFETY NOTE:** Products marked with a  have special characteristics important to safety. Before replacing any of these components, read carefully the product safety notice in this service manual. Don't degrade the safety of the product through improper servicing.

## NOTES:

- Parts that are not assigned part numbers (-----) are not available.
- Tolerance of Capacitors and Resistors are noted with the following symbols.

C.....±0.25%    D.....±0.5%    F.....±1%  
 G.....±2%    J.....±5%    K.....±10%  
 M.....±20%    N.....±30%    Z.....+80/-20%

## LCD MODULE ASSEMBLY

\*VCOM Adjustment and White Balance Adjustment are required when repairing T-CON CBA.

Ref. No.	Description	Part No.
	LCD MODULE ASSEMBLY Consists of the following:	UF320XA
	T-CON CBA CELL ACF ASSEMBLY BACKLIGHT ASSEMBLY	1FSA10238 ----- -----


## DIGITAL MAIN CBA UNIT

Ref. No.	Description	Part No.
	DIGITAL MAIN CBA UNIT	1ESA15613

## MPS CBA

Ref. No.	Description	Part No.
	MPS CBA Consists of the following	1ESA14806
	POWER SUPPLY CBA(MPS-1) FUNCTION CBA(MPS-2) IR SENSOR CBA(MPS-3) JACK CBA(MPS-4)	----- ----- ----- -----

## POWER SUPPLY CBA

Ref. No.	Description	Part No.
	POWER SUPPLY CBA(MPS-1) Consists of the following:	-----
<b>CAPACITORS</b>		
C601 	ELECTROLYTIC CAPACITOR 270µF/200V	CA2D271DYG05
C602	CERAMIC CAP. R K 680pF/2KV(HR)	CCD3DKA0R681
C604	FILM CAP.(P) 0.033µF/50V J	CA1J333MS029
C605	CERAMIC CAP.(AX) B K 0.01µF/50V	CA1J103TU011
C606	FILM CAP.(P) 0.1µF/50V J	CA1J104MS029
C608	SAFETY CAP. 4700pF/250V	CCD2EMA0E472
C633	ELECTROLYTIC CAP. 470µF/25V M	CE1EMASDL471
C634	ELECTROLYTIC CAP. 1000µF/10V M	CE1AMASDL102
C635	CERAMIC CAP.(AX) B K 0.01µF/50V	CA1J103TU011
C636	CERAMIC CAP. R K 1500pF/2KV(HR)	CCD3DKA0R152
C638	CAP ELE STD-85 4700µF 6.3V SL	CE0KMZNDL472

Ref. No.	Description	Part No.
C639	ELECTROLYTIC CAP. 1000µF/50V M	CE1JMZPDL102
C640	ELECTROLYTIC CAP. 22µF/16V M	CE1CMASDL220
C642	CAP ELE STD-85 4700µF 6.3V SL	CE0KMZNDL472
C643	CAP ALUMINUM ELECTROLYTIC 2200µF/6.3V M	CE0KMZNDL222
C644	ELECTROLYTIC CAP. 1000µF/16V M	CA1C102SP085
C647	ELECTROLYTIC CAP. 10µF/50V M	CE1JMASDL100
C648	ELECTROLYTIC CAP. 1000µF/25V M	CE1EMZNDL102
C650	ELECTROLYTIC CAP. 1µF/50V M	CE1JMASDL1R0
C652	ELECTROLYTIC CAP. 100µF/10V M	CE1AMASDL101
C653	ELECTROLYTIC CAP. 100µF/10V M	CE1AMASDL101
C655	ELECTROLYTIC CAP. 1000µF/10V M	CE1AMASDL102
C656	ELECTROLYTIC CAP. 1000µF/6.3V M	CE0KMASDL102
C657	CHIP CERAMIC CAP.(1608) F Z 0.1µF/50V	CHD1JZ30F104
C658	CHIP CERAMIC CAP.(1608) F Z 0.1µF/50V	CHD1JZ30F104
C659	CHIP CERAMIC CAP.(1608) F Z 0.1µF/50V	CHD1JZ30F104
C660	CHIP CERAMIC CAP.(1608) F Z 0.1µF/50V	CHD1JZ30F104
C661	CHIP CERAMIC CAP.(1608) F Z 0.1µF/50V	CHD1JZ30F104
C662	CHIP CERAMIC CAP.(1608) F Z 0.1µF/50V	CHD1JZ30F104
C663	ELECTROLYTIC CAP. 100µF/25V M	CE1EMASDL101
C664	CAP ELE STD-85 4700µF 6.3V SL	CE0KMZNDL472
C665	CHIP CERAMIC CAP.(1608) F Z 0.1µF/50V	CHD1JZ30F104
C801	ELECTROLYTIC CAP. 100µF/16V M	CA1C101SP085
C802	CHIP CERAMIC CAP. (1608) B K 1µF/16V	CHD1CK30B105
C803	CHIP CERAMIC CAP. (1608) B K 1µF/16V	CHD1CK30B105
C804	ELECTROLYTIC CAP. 100µF/16V M	CA1C101SP085
C805	ELECTROLYTIC CAP. 10µF/16V M	CE1CMASDL100
C806	CHIP CERAMIC CAP.(1608) B K 0.1µF/50V	CHD1JK30B104
C807	CHIP CERAMIC CAP.(1608) B K 0.1µF/50V	CHD1JK30B104
C808	ELECTROLYTIC CAP. 3.3µF/50V M	CE1JMASDL3R3
C809	CHIP CERAMIC CAP.(1608) B K 0.1µF/50V	CHD1JK30B104
C810	CHIP CERAMIC CAP.(1608) B K 0.1µF/50V	CHD1JK30B104
C811	ELECTROLYTIC CAP. 1000µF/25V M	CE1EMZNDL102
C812	CHIP CERAMIC CAP.(1608) B K 0.1µF/50V	CHD1JK30B104
C813	CHIP CERAMIC CAP.(1608) B K 0.1µF/50V	CHD1JK30B104
C814	CHIP CERAMIC CAP.(1608) B K 0.1µF/50V	CHD1JK30B104
C815	CHIP CERAMIC CAP.(1608) B K 0.1µF/50V	CHD1JK30B104
C816	ELECTROLYTIC CAP. 10µF/50V M	CE1JMASDL100
C817	CHIP CERAMIC CAP.(1608) B K 0.1µF/50V	CHD1JK30B104
C818	CHIP CERAMIC CAP.(1608) B K 0.1µF/50V	CHD1JK30B104
C819	ELECTROLYTIC CAP. 1µF/50V M	CE1JMASDL1R0
C821	ELECTROLYTIC CAP. 4.7µF/16V M	CE1CMASDL4R7
C823	CHIP CERAMIC CAP.(1608) B K 0.1µF/50V	CHD1JK30B104
C824	CHIP CERAMIC CAP. (1608) B K 1µF/16V	CHD1CK30B105
C825	CHIP CERAMIC CAP. (1608) B K 1µF/16V	CHD1CK30B105
C826	CHIP CERAMIC CAP. (1608) B K 0.1µF/50V	CHD1JK30B104
C827	ELECTROLYTIC CAP. 4.7µF/16V M	CE1CMASDL4R7
C833	CHIP CERAMIC CAP.(1608) B K 0.1µF/50V	CHD1JK30B104
C834	ELECTROLYTIC CAP. 10µF/50V M	CE1JMASDL100
C835	ELECTROLYTIC CAP. 10µF/50V M	CE1JMASDL100
C842	CHIP CERAMIC CAP. (1608) B K 1µF/16V	CHD1CK30B105
C843	CHIP CERAMIC CAP. (1608) B K 1µF/16V	CHD1CK30B105
C857	ELECTROLYTIC CAP. 100µF/16V M	CA1C101SP085
C859	ELECTROLYTIC CAP. 47µF/16V M	CA1C470SP085
C860	CHIP RES.(1608) 1/10W 0 Ω	RRXAZR5Z0000
C861	CHIP RES.(1608) 1/10W 0 Ω	RRXAZR5Z0000
C862	ELECTROLYTIC CAP. 4.7µF/16V M	CE1CMASDL4R7
C863	ELECTROLYTIC CAP. 4.7µF/16V M	CE1CMASDL4R7
C864	CHIP CERAMIC CAP.(1608) B K 0.1µF/50V	CHD1JK30B104
C865	CHIP CERAMIC CAP.(1608) B K 0.1µF/50V	CHD1JK30B104

Ref. No.	Description	Part No.
C866	CHIP CERAMIC CAP.(1608) B K 0.1μF/50V	CHD1JK30B104
C867	CHIP CERAMIC CAP.(1608) B K 0.1μF/50V	CHD1JK30B104
C868	CHIP CERAMIC CAP.(1608) B K 2700pF/50V	CHD1JK30B272
C869	CHIP CERAMIC CAP.(1608) B K 2700pF/50V	CHD1JK30B272
C870	CHIP CERAMIC CAP.(1608) B K 0.1μF/50V	CHD1JK30B104
C871	CHIP CERAMIC CAP.(1608) B K 0.01μF/50V	CHD1JK30B103
C872	CHIP CERAMIC CAP. F Z 0.068μF/50V	CHD1JZ30F683
C873	CHIP CERAMIC CAP.(1608) B K 5600pF/50V	CHD1JK30B562
C875	ELECTROLYTIC CAP. 4.7μF/16V M	CE1CMASDL4R7
C876	ELECTROLYTIC CAP. 4.7μF/16V M	CE1CMASDL4R7
C877	CHIP CERAMIC CAP. (1608) B K 1μF/16V	CHD1CK30B105
C878	CHIP CERAMIC CAP. (1608) B K 1μF/16V	CHD1CK30B105
C880	CHIP CERAMIC CAP. (1608) B K 1μF/16V	CHD1CK30B105
C1602	ALUMINUM ELECTROLYTIC CAP 1000μF/35V M	CE1GMZNTM102
C1603	CERAMIC CAP.(AX) B K 0.01μF/50V	CA1J103TU011
<b>CONNECTORS</b>		
CN101B	PH CONNECTOR TOP 8P B8B-PH-K-S (LF)(SN)	J3PHC08JG029
CN301	TWG CONNECTOR 23P TWG-P23P-A1	J3TWA23TG001
CN302	TWG CONNECTOR 23P TWG-P23P-A1	J3TWA23TG001
CN601	WIRE ASSEMBLY 004 3PIN / 130MM / AWG18	WX1A71F0-004
CN801	CONNECTOR BASE 2P(EH) B 2B-EH-A(LF)(SN)	J3EHC02JG010
CN802	CONNECTOR BASE 2P(EH) B 2B-EH-A(LF)(SN)	J3EHC02JG010
<b>DIODES</b>		
D602▲	ZENER DIODE MTZJT-7739B	QDTB00MTZJ39
D603	SWITCHING DIODE 1SS133(T-77)	QDTZ001SS133
D604▲	ZENER DIODE MTZJT-7727B	QDTB00MTZJ27
D606	ZENER DIODE MTZJT-774.3B	QDTB00MTZJ4R3
D607	SWITCHING DIODE 1SS133(T-77)	QDTZ001SS133
D611	SWITCHING DIODE 1SS133(T-77)	QDTZ001SS133
D612	SWITCHING DIODE 1SS133(T-77)	QDTZ001SS133
D613	ZENER DIODE MTZJT-776.2B	QDTB00MTZJ6R2
D631	ZENER DIODE MTZJT-775.6B	QDTB00MTZJ5R6
D632	SCHOTTKY BARRIER DIODE ERA81-004Q	QDLZRA81004Q
D633	RECTIFIER DIODE FR202-B/P	NDQZ000FR202
D635	ZENER DIODE MTZJT-7722B	QDTB00MTZJ22
D636	DIODE FR154BD	NDL1000FR154
D637	SCHOTTKY BARRIER DIODE ERB81-004	AERB81004***
D640	SCHOTTKY BARRIER DIODE ERC81-004	QDPZERC81004
D642	SWITCHING DIODE 1SS133(T-77)	QDTZ001SS133
D643	ZENER DIODE MTZJT-7712B	QDTB00MTZJ12
D644	DIODE 1ZC43(Q)	QDLZ001ZC43Q
D646	ZENER DIODE MTZJT-7718B	QDTB00MTZJ18
D647	SCHOTTKY BARRIER DIODE ERC81-004	QDPZERC81004
D649	ZENER DIODE MTZJT-7733B	QDTB00MTZJ33
D650	ZENER DIODE MTZJT-776.2C	QDTC00MTZJ6R2
D651	DIODE FR104-B	NDLZ000FR104
D652	PCB JUMPER D0.6-P5.0	JW5.0T
D653	ZENER DIODE MTZJT-7710B	QDTB00MTZJ10
D654	SCHOTTKY BARRIER DIODE ERA81-004Q	QDLZRA81004Q
D655	DIODE FR104-B	NDLZ000FR104
D656	PCB JUMPER D0.6-P5.0	JW5.0T
D657	ZENER DIODE MTZJT-776.8B	QDTB00MTZJ6R8
D658	ZENER DIODE MTZJT-775.1B	QDTB00MTZJ5R1
D659	ZENER DIODE MTZJT-7716B	QDTB00MTZJ16
D660	ZENER DIODE MTZJT-776.8B	QDTB00MTZJ6R8
D664	SWITCHING DIODE 1SS133(T-77)	QDTZ001SS133
D665	SWITCHING DIODE 1SS133(T-77)	QDTZ001SS133
D666	SWITCHING DIODE 1SS133(T-77)	QDTZ001SS133
D667	SCHOTTKY BARRIER DIODE ERA81-004Q	QDLZRA81004Q
D668	PCB JUMPER D0.6-P5.0	JW5.0T

Ref. No.	Description	Part No.
D670	SWITCHING DIODE 1SS133(T-77)	QDTZ001SS133
D673	PCB JUMPER D0.6-P5.0	JW5.0T
D676	SWITCHING DIODE 1SS133(T-77)	QDTZ001SS133
D677	SWITCHING DIODE 1SS133(T-77)	QDTZ001SS133
D801	ZENER DIODE MTZJT-7710B	QDTB00MTZJ10
D802	SWITCHING DIODE 1SS133(T-77)	QDTZ001SS133
D803	PCB JUMPER D0.6-P5.0	JW5.0T
D810	SWITCHING DIODE 1SS133(T-77)	QDTZ001SS133
D811	SWITCHING DIODE 1SS133(T-77)	QDTZ001SS133
D851	SWITCHING DIODE 1SS133(T-77)	QDTZ001SS133
D1601	SCHOTTKY BARRIER DIODE ERC84-009	QDLZERC84009
<b>ICS</b>		
IC603▲	PHOTO COUPLER LTV817MBF	NPEBLTV817MF
IC637	IC LD1117V	NSZBA0SSS046
IC801	IC POWER AMP BD5422EFS-E2	QSZBA0TRM113
IC802	IC SURROUND PROCESSOR LV1115M-TLM-E MFP24S	QSZBA0TSY050
<b>COILS</b>		
L661	CHOKE COIL 22μH-K	LLBD00PKV021
L801	COIL RADIAL LHLP10NB330M 33μH	LLF3300TU003
L802	COIL RADIAL LHLP10NB330M 33μH	LLF3300TU003
L803	COIL RADIAL LHLP10NB330M 33μH	LLF3300TU003
L804	COIL RADIAL LHLP10NB330M 33μH	LLF3300TU003
L805	INDUCTOR 22μH-K-5FT	LLARKBSTU220
L852	PCB JUMPER D0.6-P5.0	JW5.0T
<b>TRANSISTORS</b>		
Q601▲	FET MOS 2SK3563(Q)	QFWZ2SK3563Q
Q602▲	TRANSISTOR 2SC2120-O(Te2 F T)	QQS02SC2120F
Q630	TRANSISTOR KTC3199-GR-AT/P	NQS4KTC3199P
Q631	TRANSISTOR KTC3199-GR-AT/P	NQS4KTC3199P
Q632▲	PNP TRANSISTOR POWER 2SA1887(F)	QQWZ2SA1887F
Q633	TRANSISTOR KTC3199-GR-AT/P	NQS4KTC3199P
Q635	TRANSISTOR KTA1267-GR-AT/P	NQS1KTA1267P
Q636	TRANSISTOR KTC3199-GR-AT/P	NQS4KTC3199P
Q637	PNP TRANSISTOR POWER 2SA1887(F)	QQWZ2SA1887F
Q638▲	TRANSISTOR KTC3199-GR-AT/P	NQS4KTC3199P
Q643	TRANSISTOR KTC3199-GR-AT/P	NQS4KTC3199P
Q644	TRANSISTOR KTC3199-GR-AT/P	NQS4KTC3199P
Q650	TRANSISTOR KTC3199-GR-AT/P	NQS4KTC3199P
Q801	TRANSISTOR 2SC2120-Y(Te2 F T)	QQSY2SC2120F
Q802	TRANSISTOR KTC3199-GR-AT/P	NQS4KTC3199P
<b>RESISTORS</b>		
R139	CHIP RES. 1/10W J 100 Ω	RRXAJR5Z0101
R140	CHIP RES. 1/10W J 100 Ω	RRXAJR5Z0101
R601▲	METAL RES 2W J 0.33 Ω	RN02JZPZ0R33
R604	CARBON RES. 1/4W J 390k Ω	RCX4JATZ0394
R605	CARBON RES. 1/4W J 390k Ω	RCX4JATZ0394
R606	CARBON RES. 1/4W J 390k Ω	RCX4JATZ0394
R607	CARBON RES. 1/4W J 390k Ω	RCX4JATZ0394
R608	PCB JUMPER D0.6-P5.0	JW5.0T
R609	CARBON RES. 1/4W J 2.2k Ω	RCX4JATZ0222
R610	CARBON RES. 1/4W J 220 Ω	RCX4JATZ0221
R611	CARBON RES. 1/4W J 820 Ω	RCX4JATZ0821
R612	CARBON RES. 1/4W J 270 Ω	RCX4JATZ0271
R613	CARBON RES. 1/4W J 180 Ω	RCX4JATZ0181
R615	CHIP RES. 1/10W J 10k Ω	RRXAJR5Z0103
R616	CARBON RES. 1/4W J 1.2k Ω	RCX4JATZ0122
R617	CARBON RES. 1/4W J 1.2k Ω	RCX4JATZ0122
R618	METAL OXIDE FILM RES. 2W J 10 Ω	RN02100DP004
R619	METAL OXIDE FILM RES. 2W J 10 Ω	RN02100DP004
R620	METAL OXIDE FILM RES. 2W J 1 Ω	RN021R0DP004
R621	CHIP RES. 1/10W J 10k Ω	RRXAJR5Z0103
R622	CARBON RES. 1/4W J 560 Ω	RCX4JATZ0561

Ref. No.	Description	Part No.
R633	CARBON RES. 1/4W J 820 Ω	RCX4JATZ0821
R634	CARBON RES. 1/4W J 10k Ω	RCX4JATZ0103
R635	CARBON RES. 1/4W J 560 Ω	RCX4JATZ0561
R639	CHIP RES. 1/10W J 560 Ω	RRXAJR5Z0561
R641	CARBON RES. 1/4W J 1.2k Ω	RCX4JATZ0122
R642	CARBON RES. 1/4W J 2.7k Ω	RCX4JATZ0272
R643	METAL OXIDE FILM RES. 2W J 0.12 Ω	RN02R12DP004
R644	PCB JUMPER D0.6-P5.0	JW5.0T
R645	CARBON RES. 1/4W J 12k Ω	RCX4JATZ0123
R646	CARBON RES. 1/4W J 15k Ω	RCX4JATZ0153
R649	METAL OXIDE FILM RES. 1W J 100 Ω	RN01101DP003
R651	CARBON RES. 1/4W J 100 Ω	RCX4JATZ0101
R654	CARBON RES. 1/4W J 10k Ω	RCX4JATZ0103
R655	CHIP RES. 1/10W F 1.0k Ω	RRXAFR5H1001
R656	CARBON RES. 1/4W J 3.3k Ω	RCX4JATZ0332
R657	CHIP RES. 1/10W J 10k Ω	RRXAJR5Z0103
R658	CHIP RES. 1/10W F 620 Ω	RRXAFR5H6200
R660	CHIP RES. 1/10W J 10k Ω	RRXAJR5Z0103
R661	CARBON RES. 1/4W J 4.7k Ω	RCX4JATZ0472
R662	CARBON RES. 1/4W J 4.7k Ω	RCX4JATZ0472
R663	CHIP RES. 1/10W J 10k Ω	RRXAJR5Z0103
R664	CHIP RES. 1/10W F 6.8k Ω	RRXAFR5Z6801
R665	CHIP RES. 1/10W J 2.7k Ω	RRXAJR5Z0272
R666	CHIP RES. 1/10W F 2.2k Ω	RRXAFR5H2201
R667	CHIP RES. 1/10W F 82.0 k Ω	RRXAFR5H8202
R671	CARBON RES. 1/4W J 2.7k Ω	RCX4JATZ0272
R672	CARBON RES. 1/4W J 1.8k Ω	RCX4JATZ0182
R673	CARBON RES. 1/4W J 1.8k Ω	RCX4JATZ0182
R676	CHIP RES. 1/10W J 2.2k Ω	RRXAJR5Z0222
R677	CHIP RES. 1/10W J 2.2k Ω	RRXAJR5Z0222
R678	CHIP RES. 1/10W J 6.8k Ω	RRXAJR5Z0682
R682	CHIP RES. 1/10W J 100k Ω	RRXAJR5Z0104
R683	CARBON RES. 1/4W J 22k Ω	RCX4JATZ0223
R684	CHIP RES. 1/10W J 56k Ω	RRXAJR5Z0563
R691	CARBON RES. 1/4W J 1.2k Ω	RCX4JATZ0122
R692	CARBON RES. 1/4W J 33k Ω	RCX4JATZ0333
R694	CARBON RES. 1/4W J 560 Ω	RCX4JATZ0561
R695	CARBON RES. 1/4W J 560 Ω	RCX4JATZ0561
R696	CHIP RES. 1/10W J 56k Ω	RRXAJR5Z0563
R800	PCB JUMPER D0.6-P12.5	JW12.5T
R801	CHIP RES. 1/10W F 100k Ω	RRXAFR5H1003
R802	CHIP RES. 1/10W J 390k Ω	RRXAJR5Z0394
R803	CARBON RES. 1/4W J 22 Ω	RCX4JATZ0220
R804	CARBON RES. 1/4W J 1k Ω	RCX4JATZ0102
R805	CARBON RES. 1/4W J 6.8k Ω	RCX4JATZ0682
R806	CHIP RES. 1/10W J 3.3k Ω	RRXAJR5Z0332
R807	CHIP RES. 1/10W J 22k Ω	RRXAJR5Z0223
R808	CHIP RES. 1/10W F 16.0 k Ω	RRXAFR5H1602
R809	CHIP RES. 1/10W J 10k Ω	RRXAJR5Z0103
R810	CHIP RES. 1/10W F 16.0 k Ω	RRXAFR5H1602
R812	CHIP RES. 1/10W J 270k Ω	RRXAJR5Z0274
R813	CHIP RES. 1/10W F 100k Ω	RRXAFR5H1003
R814	CHIP RES. 1/10W J 10k Ω	RRXAJR5Z0103
R815	CHIP RES.(1608) 1/10W 0 Ω	RRXAZR5Z0000
R816	CHIP RES. 1/10W J 100 Ω	RRXAJR5Z0101
R817	CHIP RES. 1/10W J 4.7k Ω	RRXAJR5Z0472
R819	CHIP RES. 1/10W J 2.7k Ω	RRXAJR5Z0272
R820	CHIP RES. 1/10W J 10k Ω	RRXAJR5Z0103
R855	CHIP RES. 1/10W J 2.2k Ω	RRXAJR5Z0222
R859	CHIP RES. 1/10W J 10 Ω	RRXAJR5Z0100
R860	CHIP RES. 1/10W J 5.1k Ω	RRXAJR5Z0512
R863	CHIP RES. 1/10W J 3.6k Ω	RRXAJR5Z0362
R864	CHIP RES. 1/10W J 3.6k Ω	RRXAJR5Z0362

Ref. No.	Description	Part No.
R865	CHIP RES. 1/10W J 2.2k Ω	RRXAJR5Z0222
R866	CHIP RES. 1/10W J 2.2k Ω	RRXAJR5Z0222
R869	CHIP RES.(1608) 1/10W 0 Ω	RRXAZR5Z0000
R870	CHIP RES.(1608) 1/10W 0 Ω	RRXAZR5Z0000
<b>MISCELLANEOUS</b>		
B10	HEAT SINK PKH ASSEMBLY L3201UB	1EM420648
B11	HEAT SINK PKP ASSEMBLY L4200EA	1EM420855
BC601	PCB JUMPER D0.6-P5.0	JW5.0T
BC602	BEADS INDUCTOR FBR07HA121SB-00	LLBF00STU030
BC632	PCB JUMPER D0.6-P5.0	JW5.0T
BC633	BEADS INDUCTOR FBR07HA121SB-00	LLBF00STU030
BC634	BEADS INDUCTOR FBR07HA121SB-00	LLBF00STU030
BC635	PCB JUMPER D0.6-P5.0	JW5.0T
BC1602	PCB JUMPER D0.6-P5.0	JW5.0T
FC601	CORE FERRITE TOROIDAL HF40T18X10X10	XL04018TE001
JS612	PCB JUMPER D0.6-P7.5	JW7.5T
JS632	PCB JUMPER D0.6-P15.0	JW15.0T
JS802	PCB JUMPER D0.6-P5.0	JW5.0T
JS803	PCB JUMPER D0.6-P5.0	JW5.0T
JS1601	PCB JUMPER D0.6-P12.5	JW12.5T
L6	SCREW B-TIGHT D3X8 BIND HEAD+	GBJB3080
T601▲	TRANS POWER 7711	LTT3PC0KT025

## FUNCTION CBA

Ref. No.	Description	Part No.
	FUNCTION CBA(MPS-2) Consists of the following:	-----
<b>CAPACITORS</b>		
C108	CHIP CERAMIC CAP.(1608) F Z 0.1μF/50V	CHD1JZ30F104
C110	ZENER DIODE EDZTE61 5.6B	QD1B00EDZ5R6
<b>CONNECTOR</b>		
CN102	CONNECTOR PRINT OSU S6B-PH-K-S(LF)(SN)	J3PHC06JG030
<b>RESISTORS</b>		
R118	PCB JUMPER D0.6-P5.0	JW5.0T
R119	CHIP RES. 1/10W J 10k Ω	RRXAJR5Z0103
R120	CHIP RES. 1/10W F 6.8k Ω	RRXAFR5H6801
R121	CHIP RES. 1/10W F 4.7k Ω	RRXAFR5H4701
R122	CHIP RES. 1/10W F 2.7k Ω	RRXAFR5H2701
R123	CHIP RES. 1/10W F 2.2k Ω	RRXAFR5H2201
R124	CHIP RES. 1/10W F 1.5k Ω	RRXAFR5H1501
R125	CARBON RES. 1/4W J 220 Ω	RCX4JATZ0221
R126	CHIP RES. 1/10W F 1.5k Ω	RRXAFR5H1501
<b>SWITCHES</b>		
SW108	TACT SWITCH SKQSAB	SST0101AL038
SW109	TACT SWITCH SKQSAB	SST0101AL038
SW110	TACT SWITCH SKQSAB	SST0101AL038
SW111	TACT SWITCH SKQSAB	SST0101AL038
SW112	TACT SWITCH SKQSAB	SST0101AL038
SW113	TACT SWITCH SKQSAB	SST0101AL038
SW114	TACT SWITCH SKQSAB	SST0101AL038
<b>MISCELLANEOUS</b>		
BC102	PCB JUMPER D0.6-P5.0	JW5.0T
JS101	PCB JUMPER D0.6-P5.0	JW5.0T
JS103	PCB JUMPER D0.6-P5.0	JW5.0T

## IR SENSOR CBA

Ref. No.	Description	Part No.
	IR SENSOR CBA(MPS-3) Consists of the following:	-----
<b>CAPACITORS</b>		
C101	ELECTROLYTIC CAP. 47 $\mu$ F/16V M H7	CE1CMAVSL470
C102	CHIP CERAMIC CAP. F Z 0.01 $\mu$ F/50V	CHD1JZ30F103
C105	CHIP CERAMIC CAP.(1608) F Z 0.1 $\mu$ F/50V	CHD1JZ30F104
C106	CHIP CERAMIC CAP.(1608) F Z 0.1 $\mu$ F/50V	CHD1JZ30F104
C107	CHIP CERAMIC CAP.(1608) F Z 0.1 $\mu$ F/50V	CHD1JZ30F104
<b>CONNECTOR</b>		
CN001	PH CONNECTOR SIDE 8P S8B-PH-K-S(LF)(SN)	J3PHC08JG030
<b>DIODES</b>		
D101	LED L-53HT	NP4Z000L53HT
D102	LED 333GT/E	NPHZ00333GTE
<b>RESISTORS</b>		
R101	CHIP RES. 1/10W J 100 $\Omega$	RRXAJR5Z0101
R102	CHIP RES. 1/10W J 3.3k $\Omega$	RRXAJR5Z0332
R103	CHIP RES. 1/10W J 220 $\Omega$	RRXAJR5Z0221
R104	CHIP RES. 1/10W J 220 $\Omega$	RRXAJR5Z0221
R105	CARBON RES. 1/4W J 1k $\Omega$	RCX4JATZ0102
<b>MISCELLANEOUS</b>		
BC101	PCB JUMPER D0.6-P5.0	JW5.0T
RCV891	PHOTO LINK MODULE KSM-712TH2E	USESJR5SKK044

## JACK CBA

Ref. No.	Description	Part No.
	JACK CBA(MPS-4) Consists of the following:	-----
<b>CAPACITORS</b>		
C7001	ELECTROLYTIC CAP. 47 $\mu$ F/16V M H7	CE1CMAVSL470
C7002	CHIP CERAMIC CAP.(2125) F Z 10 $\mu$ F/10V	CHE1AZ30F106
C7003	CHIP CERAMIC CAP.(2125) F Z 10 $\mu$ F/10V	CHE1AZ30F106
C7004	CHIP CERAMIC CAP. F Z 0.47 $\mu$ F/16V	CHD1CZ30F474
C7005	CHIP CERAMIC CAP. F Z 0.47 $\mu$ F/16V	CHD1CZ30F474
C7006	CHIP CERAMIC CAP. F Z 0.47 $\mu$ F/16V	CHD1CZ30F474
C7007	CHIP CERAMIC CAP. F Z 0.47 $\mu$ F/16V	CHD1CZ30F474
C7008	CHIP CERAMIC CAP.(1608) F Z 0.1 $\mu$ F/50V	CHD1JZ30F104
C7009	CHIP CERAMIC CAP.(1608) F Z 0.1 $\mu$ F/50V	CHD1JZ30F104
C7010	CHIP CERAMIC CAP.(1608) F Z 0.1 $\mu$ F/50V	CHD1JZ30F104
C7012	CHIP CERAMIC CAP.(1608) F Z 0.1 $\mu$ F/50V	CHD1JZ30F104
C7013	CHIP CERAMIC CAP.(1608) F Z 0.1 $\mu$ F/50V	CHD1JZ30F104
C7101	ELECTROLYTIC CAP. 220 $\mu$ F/6.3V M H7	CE0KMAVSL221
C7102	CERAMIC CAP.(AX) B K 1000pF/50V	CCA1JKT0B102
C7109	CHIP CERAMIC CAP. F Z 4.7 $\mu$ F/16V(2012)	CHE1CZ30F475
C7110	CHIP CERAMIC CAP. F Z 4.7 $\mu$ F/16V(2012)	CHE1CZ30F475
C7111	ELECTROLYTIC CAP. 220 $\mu$ F/6.3V M H7	CE0KMAVSL221
C7602	CHIP CERAMIC CAP. F Z 4.7 $\mu$ F/16V(2012)	CHE1CZ30F475
C7605	CHIP CERAMIC CAP. F Z 4.7 $\mu$ F/16V(2012)	CHE1CZ30F475
C7608	CHIP CERAMIC CAP. F Z 4.7 $\mu$ F/16V(2012)	CHE1CZ30F475
C7611	CHIP CERAMIC CAP. F Z 4.7 $\mu$ F/16V(2012)	CHE1CZ30F475
C7615	CHIP CERAMIC CAP. F Z 4.7 $\mu$ F/16V(2012)	CHE1CZ30F475
C7618	CHIP CERAMIC CAP. F Z 4.7 $\mu$ F/16V(2012)	CHE1CZ30F475
C7621	CHIP CERAMIC CAP. F Z 4.7 $\mu$ F/16V(2012)	CHE1CZ30F475
C7624	CHIP CERAMIC CAP. F Z 4.7 $\mu$ F/16V(2012)	CHE1CZ30F475
C7701	CHIP CERAMIC CAP.(1608) CH J 100pF/50V	CHD1JJ3CH101
C7702	CHIP CERAMIC CAP. F Z 0.47 $\mu$ F/16V	CHD1CZ30F474
C7705	CHIP CERAMIC CAP.(1608) CH J 100pF/50V	CHD1JJ3CH101
C7706	CHIP CERAMIC CAP. F Z 0.47 $\mu$ F/16V	CHD1CZ30F474
C7709	CHIP CERAMIC CAP.(1608) CH J 100pF/50V	CHD1JJ3CH101
C7710	CHIP CERAMIC CAP. F Z 0.47 $\mu$ F/16V	CHD1CZ30F474
C7714	CHIP CERAMIC CAP.(1608) CH J 100pF/50V	CHD1JJ3CH101

Ref. No.	Description	Part No.
C7715	CHIP CERAMIC CAP.(1608) B K 0.047 $\mu$ F/50V	CHD1JK30B473
C7718	CHIP CERAMIC CAP.(1608) CH J 100pF/50V	CHD1JJ3CH101
C7719	CHIP CERAMIC CAP. F Z 0.47 $\mu$ F/16V	CHD1CZ30F474
C7723	CHIP CERAMIC CAP.(1608) CH J 100pF/50V	CHD1JJ3CH101
C7724	CHIP CERAMIC CAP.(1608) B K 0.047 $\mu$ F/50V	CHD1JK30B473
C7729	CHIP CERAMIC CAP. CH J 39pF/50V	CHD1JJ3CH390
C7730	CHIP CERAMIC CAP. F Z 0.47 $\mu$ F/16V	CHD1CZ30F474
C7733	CHIP CERAMIC CAP. CH J 39pF/50V	CHD1JJ3CH390
C7734	CHIP CERAMIC CAP. F Z 0.47 $\mu$ F/16V	CHD1CZ30F474
C7738	CHIP CERAMIC CAP. CH J 39pF/50V	CHD1JJ3CH390
C7739	CHIP CERAMIC CAP. F Z 0.47 $\mu$ F/16V	CHD1CZ30F474
C7743	CHIP CERAMIC CAP. CH J 39pF/50V	CHD1JJ3CH390
C7744	CHIP CERAMIC CAP. F Z 0.47 $\mu$ F/16V	CHD1CZ30F474
C7747	CHIP CERAMIC CAP. CH J 39pF/50V	CHD1JJ3CH390
C7748	CHIP CERAMIC CAP. F Z 0.47 $\mu$ F/16V	CHD1CZ30F474
C7751	CHIP CERAMIC CAP. CH J 39pF/50V	CHD1JJ3CH390
C7752	CHIP CERAMIC CAP. F Z 0.47 $\mu$ F/16V	CHD1CZ30F474
C7801	ELECTROLYTIC CAP. 100 $\mu$ F/16V M H7	CE1CMAVSL101
C7802	ELECTROLYTIC CAP. 100 $\mu$ F/16V M H7	CE1CMAVSL101
<b>CONNECTOR</b>		
CN7501	FMN CONNECTOR TOP 24P 24FMN-BTK-A(LF)(SN)	JCFNG24JG019
<b>IC</b>		
IC7001	IC VIDEO ANALOG INTERFACE R2A11011FP QFP 56PIN	QSZBA0RHT066
<b>COILS</b>		
L7802	PCB JUMPER D0.6-P5.0	JW5.0T
L7803	PCB JUMPER D0.6-P5.0	JW5.0T
<b>RESISTORS</b>		
R7001	CHIP RES. 1/10W J 10k $\Omega$	RRXAJR5Z0103
R7002	CHIP RES. 1/10W J 10k $\Omega$	RRXAJR5Z0103
R7101	CHIP RES. 1/10W J 75 $\Omega$	RRXAJR5Z0750
R7102	CHIP RES. 1/10W J 75 $\Omega$	RRXAJR5Z0750
R7103	CHIP RES. 1/10W J 75 $\Omega$	RRXAJR5Z0750
R7104	CHIP RES. 1/10W J 75 $\Omega$	RRXAJR5Z0750
R7105	CHIP RES.(1608) 1/10W 0 $\Omega$	RRXAZR5Z0000
R7106	CHIP RES.(1608) 1/10W 0 $\Omega$	RRXAZR5Z0000
R7111	CHIP RES. 1/10W J 75 $\Omega$	RRXAJR5Z0750
R7112	CHIP RES. 1/10W J 75 $\Omega$	RRXAJR5Z0750
R7502	PCB JUMPER D0.6-P5.0	JW5.0T
R7503	PCB JUMPER D0.6-P5.0	JW5.0T
R7504	PCB JUMPER D0.6-P5.0	JW5.0T
R7601	CHIP RES. 1/10W J 43k $\Omega$	RRXAJR5Z0433
R7602	CHIP RES. 1/10W J 27k $\Omega$	RRXAJR5Z0273
R7604	CHIP RES. 1/10W J 43k $\Omega$	RRXAJR5Z0433
R7605	CHIP RES. 1/10W J 27k $\Omega$	RRXAJR5Z0273
R7607	CHIP RES. 1/10W J 43k $\Omega$	RRXAJR5Z0433
R7608	CHIP RES. 1/10W J 27k $\Omega$	RRXAJR5Z0273
R7610	CHIP RES. 1/10W J 43k $\Omega$	RRXAJR5Z0433
R7611	CHIP RES. 1/10W J 27k $\Omega$	RRXAJR5Z0273
R7613	CHIP RES. 1/10W J 43k $\Omega$	RRXAJR5Z0433
R7614	CHIP RES. 1/10W J 27k $\Omega$	RRXAJR5Z0273
R7616	CHIP RES. 1/10W J 43k $\Omega$	RRXAJR5Z0433
R7617	CHIP RES. 1/10W J 27k $\Omega$	RRXAJR5Z0273
R7619	CHIP RES. 1/10W J 43k $\Omega$	RRXAJR5Z0433
R7620	CHIP RES. 1/10W J 27k $\Omega$	RRXAJR5Z0273
R7622	CHIP RES. 1/10W J 43k $\Omega$	RRXAJR5Z0433
R7623	CHIP RES. 1/10W J 27k $\Omega$	RRXAJR5Z0273
R7701	CHIP RES. 1/10W J 75 $\Omega$	RRXAJR5Z0750
R7702	CHIP RES. 1/10W J 100 $\Omega$	RRXAJR5Z0101
R7708	CHIP RES. 1/10W J 75 $\Omega$	RRXAJR5Z0750
R7709	CHIP RES. 1/10W J 100 $\Omega$	RRXAJR5Z0101
R7715	CHIP RES. 1/10W J 75 $\Omega$	RRXAJR5Z0750

Ref. No.	Description	Part No.
R7716	CHIP RES. 1/10W J 100 Ω	RRXAJR5Z0101
R7723	CHIP RES. 1/10W J 75 Ω	RRXAJR5Z0750
R7724	CHIP RES. 1/10W J 100 Ω	RRXAJR5Z0101
R7730	CHIP RES. 1/10W J 75 Ω	RRXAJR5Z0750
R7731	CHIP RES. 1/10W J 100 Ω	RRXAJR5Z0101
R7738	CHIP RES. 1/10W J 75 Ω	RRXAJR5Z0750
R7739	CHIP RES. 1/10W J 100 Ω	RRXAJR5Z0101
R7747	CHIP RES.(1608) 1/10W F 75 Ω	RRXAFR5H75R0
R7748	CHIP RES. 1/10W J 100 Ω	RRXAJR5Z0101
R7755	CHIP RES.(1608) 1/10W F 75 Ω	RRXAFR5H75R0
R7756	CHIP RES. 1/10W J 100 Ω	RRXAJR5Z0101
R7763	CHIP RES.(1608) 1/10W F 75 Ω	RRXAFR5H75R0
R7764	CHIP RES. 1/10W J 100 Ω	RRXAJR5Z0101
R7771	CHIP RES.(1608) 1/10W F 75 Ω	RRXAFR5H75R0
R7772	CHIP RES. 1/10W J 100 Ω	RRXAJR5Z0101
R7779	CHIP RES.(1608) 1/10W F 75 Ω	RRXAFR5H75R0
R7780	CHIP RES. 1/10W J 100 Ω	RRXAJR5Z0101
R7787	CHIP RES.(1608) 1/10W F 75 Ω	RRXAFR5H75R0
R7788	CHIP RES. 1/10W J 100 Ω	RRXAJR5Z0101
<b>MISCELLANEOUS</b>		
JK7701	JACK SW DIN PCB S 04 S4-16SH	JYEJ040SNJ01
JK7702	JACK SW RCA PCB S RCA-347HDT-02	JYRJ030YUQ01
JK7705	JACK SW DIN PCB L DIN-435C(777D)	JYEL040YUQ03
JK7706	JACK SW RCA PCB L 05 RCA-340NI-01	JYRL030YUQ14
JK7711	JACK RCA PCB S 03 RCA-347HT-03	JXRJ030YUQ01
JK7712	JACK SW RCA PCB S RCA-228H(2)NI-01	JYRJ020YUQ02
JK7713	JACK RCA PCB S 03 RCA-347HT-03	JXRJ030YUQ01
JK7714	JACK SW RCA PCB S RCA-228H(2)NI-01	JYRJ020YUQ02

## MUT CBA

Ref. No.	Description	Part No.
	MUT CBA Consists of the following	1FSA10280
	INVERTER CBA JUNCTION CBA	----- -----

## INVERTER CBA

Ref. No.	Description	Part No.
	INVERTER CBA Consists of the following:	-----
<b>CAPACITORS</b>		
C501▲	ALUMINUM ELECTROLYTIC CAP 470μF/200V M	CA2D471NC190
C504▲	METALIZED FILM CAP. 0.47μF/250V	CT2E474MS037
C505▲	METALIZED FILM CAP. 0.47μF/250V	CT2E474MS037
C510	FILM CAP.(P) 0.022μF/50V J	CA1J223MS029
C511	CERAMIC CAP.(AX) B J 390pF/50V	CCA1JUT0B391
C512	CERAMIC CAP.(AX) B J 100pF/50V	CCA1JUT0B101
C513	CERAMIC CAP.(AX) F Z 0.1μF/50V	CCA1JZTFZ104
C514	ELECTROLYTIC CAP. 10μF/50V M	CE1JMASDL100
C515	PCB JUMPER D0.6-P5.0	JW5.0T
C516	CAP POLYPROPYLENE 0.047μF/630V J	CA2K473F7001
C517	CERAMIC CAP. R K 1000pF/2KV	CCD3DKA0R102
C520	FILM CAP.(P) 0.022μF/50V J	CA1J223MS029
C551	CHIP CERAMIC CAP. F Z 0.01μF/50V	CHD1JZ30F103
C555	CERAMIC CAP. B K 1000pF/500V	CCD2JKS0B102
C556	FILM CAP.(P) 0.01μF/50V J	CA1J103MS029
C558▲	CAP ELE STD-85 4700μF/35V SL	CE1GMZNDL472
C560	ELECTROLYTIC CAP. 0.1μF/50V M	CE1JMASDL0R1
C561	CAP ELE STD-85 4700μF/35V SL	CE1GMZNDL472
C1000	CHIP CERAMIC CAP.(1608) B K 1000pF/50V	CHD1JK30B102
C1002	CHIP CERAMIC CAP.(1608) B K 1000pF/50V	CHD1JK30B102

Ref. No.	Description	Part No.
C1003	CHIP CERAMIC CAP.(1608) B K 1000pF/50V	CHD1JK30B102
C1004	CHIP CERAMIC CAP.(1608) B K 0.01μF/50V	CHD1JK30B103
C1005	CHIP CERAMIC CAP.(1608) CH J 1000pF/50V	CHD1JJ3CH102
C1006	CHIP CERAMIC CAP.(1608) B K 0.047μF/50V	CHD1JK30B473
C1007	CHIP CERAMIC CAP. CH J 330pF/50V	CHD1JJ3CH331
C1008	CHIP CERAMIC CAP. F Z 2.2μF/10V	CHD1AZ30F225
C1009	CHIP CERAMIC CAP.(1608) B K 0.1μF/50V	CHD1JK30B104
C1010	CHIP CERAMIC CAP.(1608) B K 0.1μF/50V	CHD1JK30B104
C1011	CHIP CERAMIC CAP.(1608) B K 0.47μF/10V	CHD1AK30B474
C1012	CHIP CERAMIC CAP.(1608) B K 0.47μF/10V	CHD1AK30B474
C1013	CHIP CERAMIC CAP.(1608) B K 1μF/25V	CHD1EK30B105
C1014	CHIP CERAMIC CAP.(1608) B K 0.1μF/50V	CHD1JK30B104
C1015	ELECTROLYTIC CAP. 470μF/35V M	CE1GMZNDL471
C1016	CHIP CERAMIC CAP.(1608) B K 0.1μF/50V	CHD1JK30B104
C1017	CHIP CERAMIC CAP.(1608) B K 0.1μF/50V	CHD1JK30B104
C1018	CHIP CERAMIC CAP.(1608) B K 0.1μF/50V	CHD1JK30B104
C1019	CHIP CERAMIC CAP.(1608) B K 0.1μF/50V	CHD1JK30B104
C1020	CHIP CERAMIC CAP.(1608) B K 0.1μF/50V	CHD1JK30B104
C1021	CHIP CERAMIC CAP.(1608) B K 1000pF/50V	CHD1JK30B102
C1032	ELECTROLYTIC CAP. 47μF/35V M	CE1GMASDL470
C1040	CHIP CERAMIC CAP.(1608) B K 1000pF/50V	CHD1JK30B102
C1044	CHIP CERAMIC CAP.(1608) B K 1μF/25V	CHD1EK30B105
C1046	CHIP CERAMIC CAP.(1608) B K 1μF/25V	CHD1EK30B105
C1061	CAP CERAMIC HV 15pF/3.15KV/SL/J	CCD3FJASL150
C1062	CHIP CERAMIC CAP. B K 1500pF/50V	CHD1JK30B152
C1063	CHIP CERAMIC CAP. B K 2200pF/50V	CHD1JK30B222
C1064	CAP CERAMIC HV 15pF/3.15KV/SL/J	CCD3FJASL150
C1065	CHIP CERAMIC CAP. B K 1500pF/50V	CHD1JK30B152
C1066	CHIP CERAMIC CAP. B K 2200pF/50V	CHD1JK30B222
C1067	CHIP CERAMIC CAP.(1608) B K 0.01μF/50V	CHD1JK30B103
C1100	ELECTROLYTIC CAP. 100μF/35V M	CE1GMASDL101
C1101	CHIP CERAMIC CAP.(1608) B K 0.1μF/50V	CHD1JK30B104
C1102	ELECTROLYTIC CAP. 100μF/35V M	CE1GMASDL101
C1103	CHIP CERAMIC CAP.(1608) B K 0.1μF/50V	CHD1JK30B104
C1104	CHIP CERAMIC CAP. CH J 180pF/50V	CHD1JJ3CH181
C1105	CHIP CERAMIC CAP. CH J 180pF/50V	CHD1JJ3CH181
C1106	CHIP CERAMIC CAP. CH J 180pF/50V	CHD1JJ3CH181
C1107	CHIP CERAMIC CAP. CH J 180pF/50V	CHD1JJ3CH181
C1111	CAP CERAMIC HV 15pF/3.15KV/SL/J	CCD3FJASL150
C1112	CHIP CERAMIC CAP. B K 1500pF/50V	CHD1JK30B152
C1113	CHIP CERAMIC CAP. B K 2200pF/50V	CHD1JK30B222
C1114	CAP CERAMIC HV 15pF/3.15KV/SL/J	CCD3FJASL150
C1115	CHIP CERAMIC CAP. B K 1500pF/50V	CHD1JK30B152
C1116	CHIP CERAMIC CAP. B K 2200pF/50V	CHD1JK30B222
C1117	CHIP CERAMIC CAP.(1608) B K 0.01μF/50V	CHD1JK30B103
C1161	CAP CERAMIC HV 15pF/3.15KV/SL/J	CCD3FJASL150
C1162	CHIP CERAMIC CAP. B K 1500pF/50V	CHD1JK30B152
C1163	CHIP CERAMIC CAP. B K 2200pF/50V	CHD1JK30B222
C1164	CAP CERAMIC HV 15pF/3.15KV/SL/J	CCD3FJASL150
C1165	CHIP CERAMIC CAP. B K 1500pF/50V	CHD1JK30B152
C1166	CHIP CERAMIC CAP. B K 2200pF/50V	CHD1JK30B222
C1167	CHIP CERAMIC CAP.(1608) B K 0.01μF/50V	CHD1JK30B103
C1211	CAP CERAMIC HV 15pF/3.15KV/SL/J	CCD3FJASL150
C1212	CHIP CERAMIC CAP. B K 1500pF/50V	CHD1JK30B152
C1213	CHIP CERAMIC CAP. B K 2200pF/50V	CHD1JK30B222
C1214	CAP CERAMIC HV 15pF/3.15KV/SL/J	CCD3FJASL150
C1215	CHIP CERAMIC CAP. B K 1500pF/50V	CHD1JK30B152
C1216	CHIP CERAMIC CAP. B K 2200pF/50V	CHD1JK30B222
C1217	CHIP CERAMIC CAP.(1608) B K 0.01μF/50V	CHD1JK30B103
C1250	ELECTROLYTIC CAP. 100μF/35V M	CE1GMASDL101
C1251	CHIP CERAMIC CAP.(1608) B K 0.1μF/50V	CHD1JK30B104
C1252	ELECTROLYTIC CAP. 100μF/35V M	CE1GMASDL101
C1253	CHIP CERAMIC CAP.(1608) B K 0.1μF/50V	CHD1JK30B104

Ref. No.	Description	Part No.
C1254	CHIP CERAMIC CAP. CH J 180pF/50V	CHD1JJ3CH181
C1255	CHIP CERAMIC CAP. CH J 180pF/50V	CHD1JJ3CH181
C1256	CHIP CERAMIC CAP. CH J 180pF/50V	CHD1JJ3CH181
C1257	CHIP CERAMIC CAP. CH J 180pF/50V	CHD1JJ3CH181
C1261	CAP CERAMIC HV 15pF/3.15KV/SL/J	CCD3FJASL150
C1262	CHIP CERAMIC CAP. B K 1500pF/50V	CHD1JK30B152
C1263	CHIP CERAMIC CAP. B K 2200pF/50V	CHD1JK30B222
C1264	CAP CERAMIC HV 15pF/3.15KV/SL/J	CCD3FJASL150
C1265	CHIP CERAMIC CAP. B K 1500pF/50V	CHD1JK30B152
C1266	CHIP CERAMIC CAP. B K 2200pF/50V	CHD1JK30B222
C1267	CHIP CERAMIC CAP.(1608) B K 0.01μF/50V	CHD1JK30B103
C1311	CAP CERAMIC HV 15pF/3.15KV/SL/J	CCD3FJASL150
C1312	CHIP CERAMIC CAP. B K 1500pF/50V	CHD1JK30B152
C1313	CHIP CERAMIC CAP. B K 2200pF/50V	CHD1JK30B222
C1314	CAP CERAMIC HV 15pF/3.15KV/SL/J	CCD3FJASL150
C1315	CHIP CERAMIC CAP. B K 1500pF/50V	CHD1JK30B152
C1316	CHIP CERAMIC CAP. B K 2200pF/50V	CHD1JK30B222
C1317	CHIP CERAMIC CAP.(1608) B K 0.01μF/50V	CHD1JK30B103
C1500	CHIP CERAMIC CAP.(1608) B K 0.22μF/25V	CHD1EK30B224
C1502	CHIP CERAMIC CAP.(1608) B K 0.22μF/25V	CHD1EK30B224
C1550	CHIP CERAMIC CAP.(1608) B K 0.22μF/25V	CHD1EK30B224
C1552	CHIP CERAMIC CAP.(1608) B K 0.22μF/25V	CHD1EK30B224
<b>CONNECTORS</b>		
CN501	CONNECTOR B2P3-VH(LF)(SN)	J3VH020JG001
CN1050	CONNECTOR PRINT OSU KW05-120-02-00	J30502KET001
CN1100	CONNECTOR PRINT OSU KW05-120-02-00	J30502KET001
CN1150	CONNECTOR PRINT OSU KW05-120-02-00	J30502KET001
CN1200	CONNECTOR PRINT OSU KW05-120-02-00	J30502KET001
CN1250	CONNECTOR PRINT OSU KW05-120-02-00	J30502KET001
CN1300	CONNECTOR PRINT OSU KW05-120-02-00	J30502KET001
<b>DIODES</b>		
D502▲	DIODE 1N5406	NDLZ001N5406
D503▲	DIODE 1N5406	NDLZ001N5406
D504▲	DIODE 1N5406	NDLZ001N5406
D505▲	DIODE 1N5406	NDLZ001N5406
D507	DIODE 1ZC30(Q)	QDLZ001ZC30Q
D509	DIODE FR154	NDLZ000FR154
D510	SCHOTTKY BARRIER DIODE ERA81-004Q	QDLZRA81004Q
D511	FAST RECOVERY DIODE FE201-6	QDLZ00FE2016
D512	SWITCHING DIODE 1SS133(T-77)	QDTZ001SS133
D513	DIODE 1ZC30(Q)	QDLZ001ZC30Q
D552▲	DIODE SCHOTTKY FD867-15L	QDWZFD86715L
D553▲	DIODE SCHOTTKY FD867-15L	QDWZFD86715L
D555▲	DIODE SCHOTTKY FD867-15L	QDWZFD86715L
D556	PCB JUMPER D0.6-P5.0	JW5.0T
D557	IC SHUNT REGULATOR KIA431-AT/P	NSZBA0TJY036
D558▲	DIODE SCHOTTKY FD867-15L	QDWZFD86715L
D559	DIODE 1ZC30(Q)	QDLZ001ZC30Q
D560	ZENER DIODE MTZJT-7727B	QDTB00MTZJ27
D561	PCB JUMPER D0.6-P5.0	JW5.0T
D563	SWITCHING DIODE 1SS133(T-77)	QDTZ001SS133
D1000	SWITCHING DIODE 1SS133(T-77)	QDTZ001SS133
D1001	SWITCHING DIODE 1SS133(T-77)	QDTZ001SS133
D1002	ZENER DIODE MTZJT-776.2B	QDTB0MTZJ6R2
D1003	ZENER DIODE MTZJT-776.2B	QDTB0MTZJ6R2
D1004	ZENER DIODE MTZJT-776.2B	QDTB0MTZJ6R2
D1005	ZENER DIODE MTZJT-776.2B	QDTB0MTZJ6R2
D1006	SWITCHING DIODE 1SS133(T-77)	QDTZ001SS133
D1021	SWITCHING DIODE 1SS133(T-77)	QDTZ001SS133
D1042	ZENER DIODE MTZJT-7724B	QDTB00MTZJ24
D1043	SWITCHING DIODE 1SS133(T-77)	QDTZ001SS133
D1045	ZENER DIODE MTZJT-7724B	QDTB00MTZJ24

Ref. No.	Description	Part No.
D1046	SWITCHING DIODE 1SS133(T-77)	QDTZ001SS133
D1060	SWITCHING DIODE 1SS133(T-77)	QDTZ001SS133
D1061	SWITCHING DIODE 1SS133(T-77)	QDTZ001SS133
D1062	SWITCHING DIODE 1SS133(T-77)	QDTZ001SS133
D1063	SWITCHING DIODE 1SS133(T-77)	QDTZ001SS133
D1064	SWITCHING DIODE 1SS133(T-77)	QDTZ001SS133
D1065	SWITCHING DIODE 1SS133(T-77)	QDTZ001SS133
D1066	SWITCHING DIODE 1SS133(T-77)	QDTZ001SS133
D1067	SWITCHING DIODE 1SS133(T-77)	QDTZ001SS133
D1068	SWITCHING DIODE 1SS133(T-77)	QDTZ001SS133
D1110	SWITCHING DIODE 1SS133(T-77)	QDTZ001SS133
D1111	SWITCHING DIODE 1SS133(T-77)	QDTZ001SS133
D1112	SWITCHING DIODE 1SS133(T-77)	QDTZ001SS133
D1113	SWITCHING DIODE 1SS133(T-77)	QDTZ001SS133
D1114	SWITCHING DIODE 1SS133(T-77)	QDTZ001SS133
D1115	SWITCHING DIODE 1SS133(T-77)	QDTZ001SS133
D1116	SWITCHING DIODE 1SS133(T-77)	QDTZ001SS133
D1117	SWITCHING DIODE 1SS133(T-77)	QDTZ001SS133
D1118	SWITCHING DIODE 1SS133(T-77)	QDTZ001SS133
D1160	SWITCHING DIODE 1SS133(T-77)	QDTZ001SS133
D1161	SWITCHING DIODE 1SS133(T-77)	QDTZ001SS133
D1162	SWITCHING DIODE 1SS133(T-77)	QDTZ001SS133
D1163	SWITCHING DIODE 1SS133(T-77)	QDTZ001SS133
D1164	SWITCHING DIODE 1SS133(T-77)	QDTZ001SS133
D1165	SWITCHING DIODE 1SS133(T-77)	QDTZ001SS133
D1166	SWITCHING DIODE 1SS133(T-77)	QDTZ001SS133
D1167	SWITCHING DIODE 1SS133(T-77)	QDTZ001SS133
D1168	SWITCHING DIODE 1SS133(T-77)	QDTZ001SS133
D1210	SWITCHING DIODE 1SS133(T-77)	QDTZ001SS133
D1211	SWITCHING DIODE 1SS133(T-77)	QDTZ001SS133
D1212	SWITCHING DIODE 1SS133(T-77)	QDTZ001SS133
D1213	SWITCHING DIODE 1SS133(T-77)	QDTZ001SS133
D1214	SWITCHING DIODE 1SS133(T-77)	QDTZ001SS133
D1215	SWITCHING DIODE 1SS133(T-77)	QDTZ001SS133
D1216	SWITCHING DIODE 1SS133(T-77)	QDTZ001SS133
D1217	SWITCHING DIODE 1SS133(T-77)	QDTZ001SS133
D1218	SWITCHING DIODE 1SS133(T-77)	QDTZ001SS133
D1260	SWITCHING DIODE 1SS133(T-77)	QDTZ001SS133
D1261	SWITCHING DIODE 1SS133(T-77)	QDTZ001SS133
D1262	SWITCHING DIODE 1SS133(T-77)	QDTZ001SS133
D1263	SWITCHING DIODE 1SS133(T-77)	QDTZ001SS133
D1264	SWITCHING DIODE 1SS133(T-77)	QDTZ001SS133
D1265	SWITCHING DIODE 1SS133(T-77)	QDTZ001SS133
D1266	SWITCHING DIODE 1SS133(T-77)	QDTZ001SS133
D1267	SWITCHING DIODE 1SS133(T-77)	QDTZ001SS133
D1268	SWITCHING DIODE 1SS133(T-77)	QDTZ001SS133
D1310	SWITCHING DIODE 1SS133(T-77)	QDTZ001SS133
D1311	SWITCHING DIODE 1SS133(T-77)	QDTZ001SS133
D1312	SWITCHING DIODE 1SS133(T-77)	QDTZ001SS133
D1313	SWITCHING DIODE 1SS133(T-77)	QDTZ001SS133
D1314	SWITCHING DIODE 1SS133(T-77)	QDTZ001SS133
D1315	SWITCHING DIODE 1SS133(T-77)	QDTZ001SS133
D1316	SWITCHING DIODE 1SS133(T-77)	QDTZ001SS133
D1317	SWITCHING DIODE 1SS133(T-77)	QDTZ001SS133
D1318	SWITCHING DIODE 1SS133(T-77)	QDTZ001SS133
D1500	SWITCHING DIODE 1SS133(T-77)	QDTZ001SS133
D1501	SWITCHING DIODE 1SS133(T-77)	QDTZ001SS133
D1502	SWITCHING DIODE 1SS133(T-77)	QDTZ001SS133
D1503	SWITCHING DIODE 1SS133(T-77)	QDTZ001SS133
D1550	SWITCHING DIODE 1SS133(T-77)	QDTZ001SS133
D1551	SWITCHING DIODE 1SS133(T-77)	QDTZ001SS133
D1552	SWITCHING DIODE 1SS133(T-77)	QDTZ001SS133
D1553	SWITCHING DIODE 1SS133(T-77)	QDTZ001SS133



Ref. No.	Description	Part No.
D1701	ZENER DIODE MTZJT-7718B	QDTB00MTZJ18
D1702	ZENER DIODE MTZJT-773.3B	QDTB0MTZJ3R3
<b>ICS</b>		
IC501	IC UCC28600DR SOIC 8PIN	NSZAA0TTY017
IC509▲	PHOTO COUPLER LTV817MBF	NPEBLTV817MF
IC510▲	PHOTO COUPLER LTV817MBF	NPEBLTV817MF
IC1001	IC INVERTER CONTROLLER OZ9966SN-B1-0-TR/SSO	NSZBA0TTMC06
IC1500	IC BA10324AF-E2	QSZBA0TRM032
IC1550	IC BA10324AF-E2	QSZBA0TRM032
<b>COILS</b>		
L502▲	FILTER LLBG00ZY2015	LLBG00ZY2015
L503▲	FILTER LLBG00ZY2015	LLBG00ZY2015
<b>TRANSISTORS</b>		
Q501▲	FET MOS 2SK3561(Q) IDSS100UA	QFWZ2SK3561Q
Q502	TRANSISTOR KTC3199-GR-AT/P	NQS4KTC3199P
Q551	TRANSISTOR KTC3199-GR-AT/P	NQS4KTC3199P
Q552	TRANSISTOR KTC3199-GR-AT/P	NQS4KTC3199P
Q1001	TRANSISTOR KTC3199-GR-AT/P	NQS4KTC3199P
Q1002	TRANSISTOR KTC3199-GR-AT/P	NQS4KTC3199P
Q1003	TRANSISTOR KTC3199-GR-AT/P	NQS4KTC3199P
Q1020	TRANSISTOR KTA1267-GR-AT/P	NQS1KTA1267P
Q1100	MOS FET 2SK2614	QF1Z2SK2614Q
Q1101	MOS FET 2SK2614	QF1Z2SK2614Q
Q1102	MOS FET 2SK2614	QF1Z2SK2614Q
Q1103	MOS FET 2SK2614	QF1Z2SK2614Q
Q1250	MOS FET 2SK2614	QF1Z2SK2614Q
Q1251	MOS FET 2SK2614	QF1Z2SK2614Q
Q1252	MOS FET 2SK2614	QF1Z2SK2614Q
Q1253	MOS FET 2SK2614	QF1Z2SK2614Q
Q1701	TRANSISTOR KTA1267-GR-AT/P	NQS1KTA1267P
<b>RESISTORS</b>		
R501▲	CEMENT RESISTOR 5W J 0.47 Ω	RW05R47PAK10
R503▲	CARBON RES. 1/2W J 3.3M Ω	RCX2JZQZ0335
R505▲	METAL OXIDE FILM RES. 2W J 0.15 Ω	RN02R15DP004
R506	CARBON RES. 1/4W J 10k Ω	RCX4JATZ0103
R507	CARBON RES. 1/4W J 1k Ω	RCX4JATZ0102
R509	PCB JUMPER D0.6-P5.0	JW5.0T
R510▲	CARBON RES. 1/4W J 120k Ω	RCX4JATZ0124
R511	CARBON RES. 1/4W J 120k Ω	RCX4JATZ0124
R512	CARBON RES. 1/4W J 120k Ω	RCX4JATZ0124
R513	CARBON RES. 1/4W J 22 Ω	RCX4JATZ0220
R514	CARBON RES. 1/4W J 22 Ω	RCX4JATZ0220
R515	CARBON RES. 1/4W J 220k Ω	RCX4JATZ0224
R516	CARBON RES. 1/4W J 27k Ω	RCX4JATZ0273
R517▲	CARBON RES. 1/4W J 560k Ω	RCX4JATZ0564
R518	CARBON RES. 1/4W J 560k Ω	RCX4JATZ0564
R519	CARBON RES. 1/4W J 560k Ω	RCX4JATZ0564
R520	METAL OXIDE FILM RES. 3W J 10 Ω	RN03100ZU001
R521	CARBON RES. 1/4W J 330k Ω	RCX4JATZ0334
R522	METAL OXIDE RES. 3W J 18k Ω	RN03183ZU001
R523	PCB JUMPER D0.6-P5.0	JW5.0T
R524	METAL OXIDE RES. 3W J 18k Ω	RN03183ZU001
R551	CHIP RES. 1/10W J 5.6k Ω	RRXAJR5Z0562
R553	CHIP RES. 1/10W J 2.2k Ω	RRXAJR5Z0222
R554	CHIP RES. 1/10W F 4.7k Ω	RRXAFR5H4701
R555	CHIP RES. 1/10W J 820 Ω	RRXAJR5Z0821
R556	PCB JUMPER D0.6-P5.0	JW5.0T
R557	CHIP RES. 1/10W F 2.2k Ω	RRXAFR5H2201
R558	CHIP RES. 1/10W F 6.8k Ω	RRXAFR5H6801
R559	CHIP RES. 1/10W F 6.8k Ω	RRXAFR5H6801
R560	CHIP RES. 1/10W F 5.6k Ω	RRXAFR5H5601
R562	CHIP RES. 1/10W J 3.3k Ω	RRXAJR5Z0332

Ref. No.	Description	Part No.
R564	CARBON RES. 1/4W J 2.7k Ω	RCX4JATZ0272
R565	CHIP RES. 1/10W J 10k Ω	RRXAJR5Z0103
R566	METAL OXIDE FILM RES. 2W J 1.5k Ω	RN02152ZU001
R567	METAL OXIDE FILM RES. 2W J 1.5k Ω	RN02152ZU001
R568	CHIP RES. 1/10W J 5.6k Ω	RRXAJR5Z0562
R571	CHIP RES. 1/10W J 22k Ω	RRXAJR5Z0223
R572	CHIP RES. 1/10W J 3.3k Ω	RRXAJR5Z0332
R1000	CHIP RES. 1/10W J 20k Ω	RRXAJR5Z0203
R1001	CHIP RES. 1/10W J 10k Ω	RRXAJR5Z0103
R1002	CARBON RES. 1/4W J 5.1k Ω	RCX4JATZ0512
R1003	CHIP RES. 1/10W J 220k Ω	RRXAJR5Z0224
R1004	CHIP RES. 1/10W J 10k Ω	RRXAJR5Z0103
R1005	CHIP RES. 1/10W F 160 k Ω	RRXAFR5H1603
R1006	CHIP RES. 1/10W J 10k Ω	RRXAJR5Z0103
R1007	CHIP RES. 1/10W J 1M Ω	RRXAJR5Z0105
R1008	CHIP RES. 1/10W J 51k Ω	RRXAJR5Z0513
R1009	CHIP RES. 1/10W F 1M Ω	RRXAFR5H1004
R1010	CHIP RES. 1/10W F 120 k Ω	RRXAFR5H1203
R1011	CHIP RES. 1/10W F 120 k Ω	RRXAFR5H1203
R1012	CHIP RES. 1/10W J 68k Ω	RRXAJR5Z0683
R1013	CHIP RES. 1/10W J 10k Ω	RRXAJR5Z0103
R1014	CARBON RES. 1/4W J 51k Ω	RCX4JATZ0513
R1015	CHIP RES.(1608) 1/10W F 5.1k Ω	RRXAFR5H0512
R1020	CHIP RES. 1/10W J 1M Ω	RRXAJR5Z0105
R1040	CARBON RES. 1/4W J 4.7k Ω	RCX4JATZ0472
R1041	CHIP RES. 1/10W J 10k Ω	RRXAJR5Z0103
R1042	CHIP RES. 1/10W J 22k Ω	RRXAJR5Z0223
R1043	CHIP RES. 1/10W J 22k Ω	RRXAJR5Z0223
R1045	CHIP RES. 1/10W J 47k Ω	RRXAJR5Z0473
R1046	CARBON RES. 1/4W J 6.8k Ω	RCX4JATZ0682
R1047	CHIP RES. 1/10W J 1M Ω	RRXAJR5Z0105
R1048	CHIP RES. 1/10W J 1k Ω	RRXAJR5Z0102
R1050	CHIP RES. 1/10W J 47k Ω	RRXAJR5Z0473
R1051	CARBON RES. 1/4W J 6.8k Ω	RCX4JATZ0682
R1052	CHIP RES. 1/10W J 1M Ω	RRXAJR5Z0105
R1053	CHIP RES. 1/10W J 1k Ω	RRXAJR5Z0102
R1060	CARBON RES. 1/4W J 100k Ω	RCX4JATZ0104
R1061	CHIP RES. 1/10W J 20k Ω	RRXAJR5Z0203
R1062	CHIP RES. 1/10W F 750 Ω	RRXAFR5H7500
R1063	CARBON RES. 1/4W J 5.1k Ω	RCX4JATZ0512
R1064	CHIP RES. 1/10W J 100k Ω	RRXAJR5Z0104
R1065	CHIP RES. 1/10W J 20k Ω	RRXAJR5Z0203
R1066	CHIP RES. 1/10W F 750 Ω	RRXAFR5H7500
R1067	CHIP RES. 1/10W J 5.1k Ω	RRXAJR5Z0512
R1068	CHIP RES. 1/10W F 8.2k Ω	RRXAFR5H8201
R1069	CHIP RES. 1/10W F 8.2k Ω	RRXAFR5H8201
R1070	CHIP RES. 1/10W J 1M Ω	RRXAJR5Z0105
R1071	CHIP RES. 1/10W J 1k Ω	RRXAJR5Z0102
R1100	CHIP RES.(1608) 1/10W 0 Ω	RRXAZR5Z0000
R1101	CHIP RES.(1608) 1/10W 0 Ω	RRXAZR5Z0000
R1102	CHIP RES.(1608) 1/10W 0 Ω	RRXAZR5Z0000
R1103	CHIP RES.(1608) 1/10W 0 Ω	RRXAZR5Z0000
R1104	PCB JUMPER D0.6-P5.0	JW5.0T
R1105	PCB JUMPER D0.6-P5.0	JW5.0T
R1110	CARBON RES. 1/4W J 100k Ω	RCX4JATZ0104
R1111	CHIP RES. 1/10W J 20k Ω	RRXAJR5Z0203
R1112	CHIP RES. 1/10W F 750 Ω	RRXAFR5H7500
R1113	CHIP RES. 1/10W J 5.1k Ω	RRXAJR5Z0512
R1114	CARBON RES. 1/4W J 100k Ω	RCX4JATZ0104
R1115	CHIP RES. 1/10W J 20k Ω	RRXAJR5Z0203
R1116	CHIP RES. 1/10W F 750 Ω	RRXAFR5H7500
R1117	CARBON RES. 1/4W J 5.1k Ω	RCX4JATZ0512
R1118	CHIP RES. 1/10W F 8.2k Ω	RRXAFR5H8201

Ref. No.	Description	Part No.
R1119	CHIP RES. 1/10W F 8.2k $\Omega$	RRXAFR5H8201
R1120	CHIP RES. 1/10W J 1M $\Omega$	RRXAJR5Z0105
R1121	CARBON RES. 1/4W J 1k $\Omega$	RCX4JATZ0102
R1160	CARBON RES. 1/4W J 100k $\Omega$	RCX4JATZ0104
R1161	CHIP RES. 1/10W J 20k $\Omega$	RRXAJR5Z0203
R1162	CHIP RES. 1/10W F 750 $\Omega$	RRXAFR5H7500
R1163	CARBON RES. 1/4W J 5.1k $\Omega$	RCX4JATZ0512
R1164	CHIP RES. 1/10W J 100k $\Omega$	RRXAJR5Z0104
R1165	CHIP RES. 1/10W J 20k $\Omega$	RRXAJR5Z0203
R1166	CHIP RES. 1/10W F 750 $\Omega$	RRXAFR5H7500
R1167	CARBON RES. 1/4W J 5.1k $\Omega$	RCX4JATZ0512
R1168	CHIP RES. 1/10W F 8.2k $\Omega$	RRXAFR5H8201
R1169	CHIP RES. 1/10W F 8.2k $\Omega$	RRXAFR5H8201
R1170	CHIP RES. 1/10W J 1M $\Omega$	RRXAJR5Z0105
R1171	CARBON RES. 1/4W J 1k $\Omega$	RCX4JATZ0102
R1210	CHIP RES. 1/10W J 100k $\Omega$	RRXAJR5Z0104
R1211	CHIP RES. 1/10W J 20k $\Omega$	RRXAJR5Z0203
R1212	CHIP RES. 1/10W F 750 $\Omega$	RRXAFR5H7500
R1213	CARBON RES. 1/4W J 5.1k $\Omega$	RCX4JATZ0512
R1214	CHIP RES. 1/10W J 100k $\Omega$	RRXAJR5Z0104
R1215	CHIP RES. 1/10W J 20k $\Omega$	RRXAJR5Z0203
R1216	CHIP RES. 1/10W F 750 $\Omega$	RRXAFR5H7500
R1217	CHIP RES. 1/10W J 5.1k $\Omega$	RRXAJR5Z0512
R1218	CHIP RES. 1/10W F 8.2k $\Omega$	RRXAFR5H8201
R1219	CHIP RES. 1/10W F 8.2k $\Omega$	RRXAFR5H8201
R1220	CHIP RES. 1/10W J 1M $\Omega$	RRXAJR5Z0105
R1221	CARBON RES. 1/4W J 1k $\Omega$	RCX4JATZ0102
R1250	CHIP RES.(1608) 1/10W 0 $\Omega$	RRXAZR5Z0000
R1251	CHIP RES.(1608) 1/10W 0 $\Omega$	RRXAZR5Z0000
R1252	CHIP RES.(1608) 1/10W 0 $\Omega$	RRXAZR5Z0000
R1253	CHIP RES.(1608) 1/10W 0 $\Omega$	RRXAZR5Z0000
R1254	PCB JUMPER D0.6-P5.0	JW5.0T
R1255	PCB JUMPER D0.6-P5.0	JW5.0T
R1260	CARBON RES. 1/4W J 100k $\Omega$	RCX4JATZ0104
R1261	CHIP RES. 1/10W J 20k $\Omega$	RRXAJR5Z0203
R1262	CHIP RES. 1/10W F 750 $\Omega$	RRXAFR5H7500
R1263	CARBON RES. 1/4W J 5.1k $\Omega$	RCX4JATZ0512
R1264	CARBON RES. 1/4W J 100k $\Omega$	RCX4JATZ0104
R1265	CHIP RES. 1/10W J 20k $\Omega$	RRXAJR5Z0203
R1266	CHIP RES. 1/10W F 750 $\Omega$	RRXAFR5H7500
R1267	CARBON RES. 1/4W J 5.1k $\Omega$	RCX4JATZ0512
R1268	CHIP RES. 1/10W F 8.2k $\Omega$	RRXAFR5H8201
R1269	CHIP RES. 1/10W F 8.2k $\Omega$	RRXAFR5H8201
R1270	CHIP RES. 1/10W J 1M $\Omega$	RRXAJR5Z0105
R1271	CARBON RES. 1/4W J 1k $\Omega$	RCX4JATZ0102
R1310	CARBON RES. 1/4W J 100k $\Omega$	RCX4JATZ0104
R1311	CHIP RES. 1/10W J 20k $\Omega$	RRXAJR5Z0203
R1312	CHIP RES. 1/10W F 750 $\Omega$	RRXAFR5H7500
R1313	CHIP RES. 1/10W J 5.1k $\Omega$	RRXAJR5Z0512
R1314	CHIP RES. 1/10W J 100k $\Omega$	RRXAJR5Z0104
R1315	CHIP RES. 1/10W J 20k $\Omega$	RRXAJR5Z0203
R1316	CHIP RES. 1/10W F 750 $\Omega$	RRXAFR5H7500
R1317	CHIP RES. 1/10W J 5.1k $\Omega$	RRXAJR5Z0512
R1318	CHIP RES. 1/10W F 8.2k $\Omega$	RRXAFR5H8201
R1319	CHIP RES. 1/10W F 8.2k $\Omega$	RRXAFR5H8201
R1320	CHIP RES. 1/10W J 1M $\Omega$	RRXAJR5Z0105
R1321	CHIP RES. 1/10W J 1k $\Omega$	RRXAJR5Z0102
R1500	CHIP RES. 1/10W F 47.0 k $\Omega$	RRXAFR5H4702
R1501	CHIP RES. 1/10W F 1.0k $\Omega$	RRXAFR5H1001
R1504	CHIP RES. 1/10W J 100k $\Omega$	RRXAJR5Z0104
R1505	CHIP RES. 1/10W J 10k $\Omega$	RRXAJR5Z0103
R1506	CHIP RES. 1/10W J 100k $\Omega$	RRXAJR5Z0104
R1507	CHIP RES. 1/10W J 10k $\Omega$	RRXAJR5Z0103

Ref. No.	Description	Part No.
R1508	CARBON RES. 1/4W J 100k $\Omega$	RCX4JATZ0104
R1509	CHIP RES. 1/10W J 10k $\Omega$	RRXAJR5Z0103
R1510	CHIP RES. 1/10W J 100k $\Omega$	RRXAJR5Z0104
R1511	CHIP RES. 1/10W J 10k $\Omega$	RRXAJR5Z0103
R1550	CHIP RES. 1/10W F 47.0 k $\Omega$	RRXAFR5H4702
R1551	CHIP RES. 1/10W F 1.0k $\Omega$	RRXAFR5H1001
R1554	CHIP RES. 1/10W J 100k $\Omega$	RRXAJR5Z0104
R1555	CHIP RES. 1/10W J 10k $\Omega$	RRXAJR5Z0103
R1556	CHIP RES. 1/10W J 100k $\Omega$	RRXAJR5Z0104
R1557	CHIP RES. 1/10W J 10k $\Omega$	RRXAJR5Z0103
R1558	CARBON RES. 1/4W J 100k $\Omega$	RCX4JATZ0104
R1559	CHIP RES. 1/10W J 10k $\Omega$	RRXAJR5Z0103
R1560	CHIP RES. 1/10W J 100k $\Omega$	RRXAJR5Z0104
R1561	CHIP RES. 1/10W J 10k $\Omega$	RRXAJR5Z0103
R1701	CHIP RES. 1/10W J 1k $\Omega$	RRXAJR5Z0102
R1702	CHIP RES. 1/10W J 2.2k $\Omega$	RRXAJR5Z0222
R1703	CHIP RES. 1/10W J 100 $\Omega$	RRXAJR5Z0101
<b>MISCELLANEOUS</b>		
AC501▲	AC CORD W/O A GND WIRE UL 1935MM BLACK	WAC0192LW003
B12	HEAT SINK PMI ASSEMBLY A71F0 $\mu$ H	1EM424257
BC501	BEADS INDUCTOR FBR07HA121SB-00	LLBF00STU030
BC502	BEADS INDUCTOR FBR07HA121SB-00	LLBF00STU030
BC552	BEADS INDUCTOR FBR07HA121SB-00	LLBF00STU030
BC553	BEADS INDUCTOR FBR07HA121SB-00	LLBF00STU030
BC1000	PCB JUMPER D0.6-P5.0	JW5.0T
BC1001	BEADS INDUCTOR FBR07HA121SB-00	LLBF00STU030
BC1050	PCB JUMPER D0.6-P12.5	JW12.5T
BC1051	PCB JUMPER D0.6-P12.5	JW12.5T
BC1100	PCB JUMPER D0.6-P10.0	JW10.0T
BC1101	PCB JUMPER D0.6-P10.0	JW10.0T
BC1150	PCB JUMPER D0.6-P12.5	JW12.5T
BC1151	PCB JUMPER D0.6-P12.5	JW12.5T
BC1200	PCB JUMPER D0.6-P10.0	JW10.0T
BC1201	PCB JUMPER D0.6-P10.0	JW10.0T
BC1250	PCB JUMPER D0.6-P10.0	JW10.0T
BC1251	PCB JUMPER D0.6-P10.0	JW10.0T
BC1300	PCB JUMPER D0.6-P10.0	JW10.0T
BC1301	PCB JUMPER D0.6-P10.0	JW10.0T
CLN552	WIRE ASSEMBLY 001 8PIN / 190MM / AWG26	WX1A71F0-001
F501▲	FUSE STC4A125V U/CT	PAGE20CW3402
FC501	CORE FERRITE TOROIDAL HF40T18X10X10	XL04018TE001
FH501	FUSE HOLDER MSF-015 LF (B110)	XH01Z00LY002
FH502	FUSE HOLDER MSF-015 LF (B110)	XH01Z00LY002
GP501▲	GAP. FNR-G3.10D	FAZ000LD6005
JS553	PCB JUMPER D0.6-P5.0	JW5.0T
JW501	PCB JUMPER D0.6-P15.0	JW15.0T
L6	SCREW B-TIGHT D3X8 BIND HEAD+	GBJB3080
SA502▲	SURGE ABSORBER 470V+-10PER	NVQZ10D471KB
T501▲	TRANS POWER 7715	LTT3PC0KT024
T1050	TRANS INVERTER ETJV23ZF2LAC	LTZ2PC0MS008
T1100	TRANS INVERTER ETJV23ZF2LAC	LTZ2PC0MS008
T1150	TRANS INVERTER ETJV23ZF2LAC	LTZ2PC0MS008
T1200	TRANS INVERTER ETJV23ZF2LAC	LTZ2PC0MS008
T1250	TRANS INVERTER ETJV23ZF2LAC	LTZ2PC0MS008
T1300	TRANS INVERTER ETJV23ZF2LAC	LTZ2PC0MS008

## JUNCTION CBA

Ref. No.	Description	Part No.
	JUNCTION CBA Consists of the following:	-----
<b>CONNECTOR</b>		
CN552	242 SERIES CONNECTOR TUC-P08X-B1 WHT ST	JCTUB08TG002

## DIGITAL SUB CBA

Ref. No.	Description	Part No.
	DIGITAL SUB CBA Consists of the following:	1ESA15014
<b>CONNECTOR</b>		
CN1	ANGLE PIN HEADER IMSA6029B105Z003PT1	JTED005ER045
<b>TRANSISTORS</b>		
Q1	PNP TRANSISTOR POWER 2SA1887(F)	QQWZ2SA1887F
Q2	PNP TRANSISTOR POWER 2SA1887(F)	QQWZ2SA1887F
Q3	PNP TRANSISTOR POWER 2SA1887(F)	QQWZ2SA1887F
<b>RESISTORS</b>		
R1	METAL OXIDE FILM RES. 2W J 0.68 $\Omega$	RN02R68DP004
R3	METAL OXIDE FILM RES. 2W J 0.68 $\Omega$	RN02R68DP004
R4	METAL OXIDE FILM RES. 2W J 0.68 $\Omega$	RN02R68DP004
R5	METAL OXIDE FILM RES. 2W J 0.68 $\Omega$	RN02R68DP004